

Arc Weld Studs - No Thread Studs

NTJ - NO THREAD "J" BOLT WELD STUDS - TECHNICAL DETAILS

NTJ weld studs are available in mild steel and stainless steel materials.

NTJ studs are commonly used for lifting parts and for assembly attachment.

To stud weld NTJ studs, special chucks are required and the dual leg ferrule foot plate is preferred.

For application, dimensional and in stock assistance, please contact Sunbelt Stud Welding.

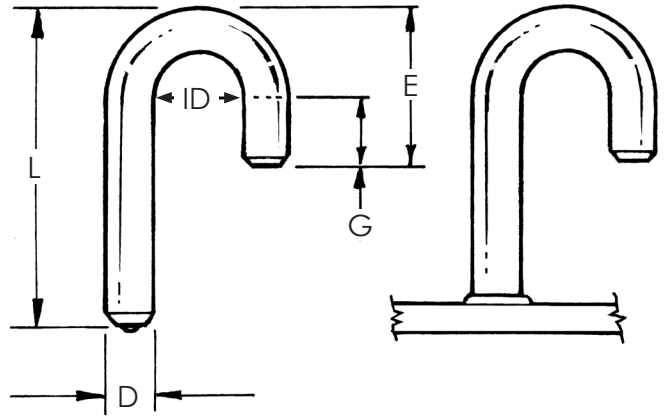

Stud Specifications						Standard Accessories		
Base Diameter	Minimum Length	Minimum Bend Length	Minimum Inside Diameter	Minimum End Length	Ferrule	Foot	Grip	Chuck
D	L	E	ID	G	P/N	P/N	P/N	P/N
0.188	1.125	1.000	0.500	0.500	F019-F	QN-018	n/a	JB-018
0.250	1.250	1.125	0.625	0.500	F025-F	QN-025	n/a	JB-025
0.312	1.500	1.250	0.750	0.500	F031-F	QN-031	n/a	JB-031
0.375	1.625	1.375	0.875	0.500	F037-F	QN-037	n/a	JB-037
0.438	1.750	1.500	1.000	0.500	F043-F	QN-043	n/a	JB-043
0.500	2.000	1.500	1.000	0.500	F050-F	QN-050	n/a	JB-050
0.625	2.500	1.875	1.500	0.500	F050-F	QN-050	n/a	JB-062

To order or specify give: Stud Code, D x L; E; ID, Material and Quantity

Example: NTJ, 1/2 x 3, (BW), with 2 x 1.25, 304SS, 1000 pcs.

Specify (L) Length, on a Before Weld basis by indicating "BW"
or on an After Weld basis by indicating "AW."

See **Accessories** for accessory detail and **Ferrule Specifications** for ferrule options.

See **Arc Stud Welding – General Information** and **Technical Details** for industry specifications, thread options, Before Weld (BW) length, flux, raw material details, plating options, annealing, load strengths and shipping weights.

