

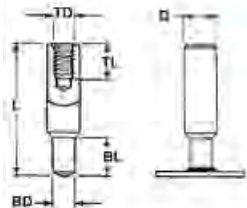

**ARC STUDS: TAPPED  
REDUCED BASE**

**To order or specify give:**

Product Code:	Base Diameter:	Base Length:	Thread Diameter:	Thread Length:	Material: Specify
<b>ARC</b>	Specify <b>BD</b>	Specify <b>BL</b>	Specify <b>TD</b>	Specify <b>TL</b>	
<b>TAPRB</b>					



STUD						
D	MIN L	TD	TL*	BD	BL	FERRULE CODE
3/8	1-1/2	1/4-20	3/8	.250	7/16	FS250
1/2	1-1/2	3/8-16	9/16	.375	7/16	FS375
5/8	1-1/2	7/16-14	21/32	.500	1/2	FS500
3/4	1-1/2	1/2-13	3/4	.500	1/2	FS500
7/8	2	5/8-11	15/16	.625	5/8	FS625
1"	2-1/2	3/4-10	1"	.750	5/8	FS750

\* Maximum standard tap depth equals 1-1/2 times tap diameter. **TAPS:** Standard tap is UNC-2B, other taps are available.

<b>MATERIAL</b>	<b>MILD STEEL</b>	<b>STAINLESS STEEL</b>	
	C - 0.23% max. Mn - 0.90% max.	P - 0.04% max. S - 0.05% max.	AISI grade - 302/304/305/316 std. Other grades available upon request.
<b>MECHANICAL PROPERTIES</b>	Tensile .....	75,000 psi (min.)	Values for various grades available upon request.
	Yield .....	64,000 psi (min.)	
	Elongation.....	20% (in 2 inches)	
<b>PLATING</b>	Plating is not standard. Cadmium, Copper, Nickel, and Zinc available upon customer request.		Does not apply to Stainless.

[www.sunbeltstudwelding.com](http://www.sunbeltstudwelding.com)

**Sunbelt Stud Welding, Inc.**  
6381 Windfern Road  
Houston, Texas 77040-4915



**1-800-462-9353**  
**713-939-8903**  
**fax 713-939-9013**