

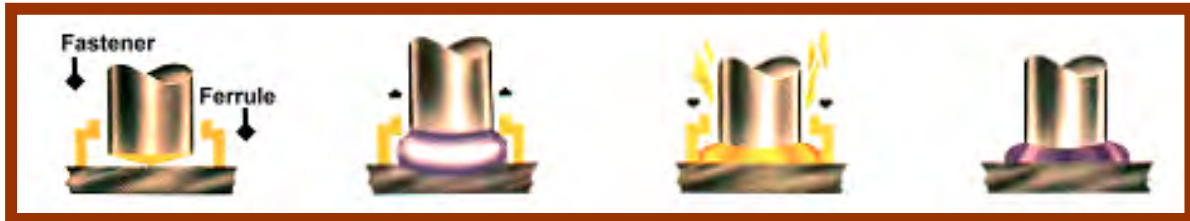

WHAT IS ARC STUD WELDING?

Arc stud welding is generally used to weld large diameter fasteners to rougher and thicker base metals. **Arc** studs may be almost any shape and there are literally hundreds, however, they must have one end of the fastener designed for **Arc** welding. Mild steel, stainless steel, and aluminum are applicable materials for **Arc** stud welding.



(1)

A fastener and a ceramic ferrule are firmly placed against the work surface under spring tension.

(2)

Upon triggering, the weld gun automatically lifts the fastener from the base metal and initiates a controlled electric arc which melts the end of the fastener and a portion of the base metal.

(3)

A ceramic arc shield concentrates the heat and retains the molten material in the weld area for maximum weld strength and reliability.

(4)

At the precise moment the fastener and the parent metal become molten, the fastener is automatically plunged into the work surface. The metal solidifies and a high quality fusion weld is completed.

www.sunbeltstudwelding.com

Sunbelt Stud Welding, Inc.
6381 Windfern Road
Houston, Texas 77040-4915



9-1

1-800-462-9353
713-939-8903
fax 713-939-9013



ARC WELD STUDS

“STANDARD” ARC WELD STUDS (OTHER STUDS AVAILABLE ON REQUEST)

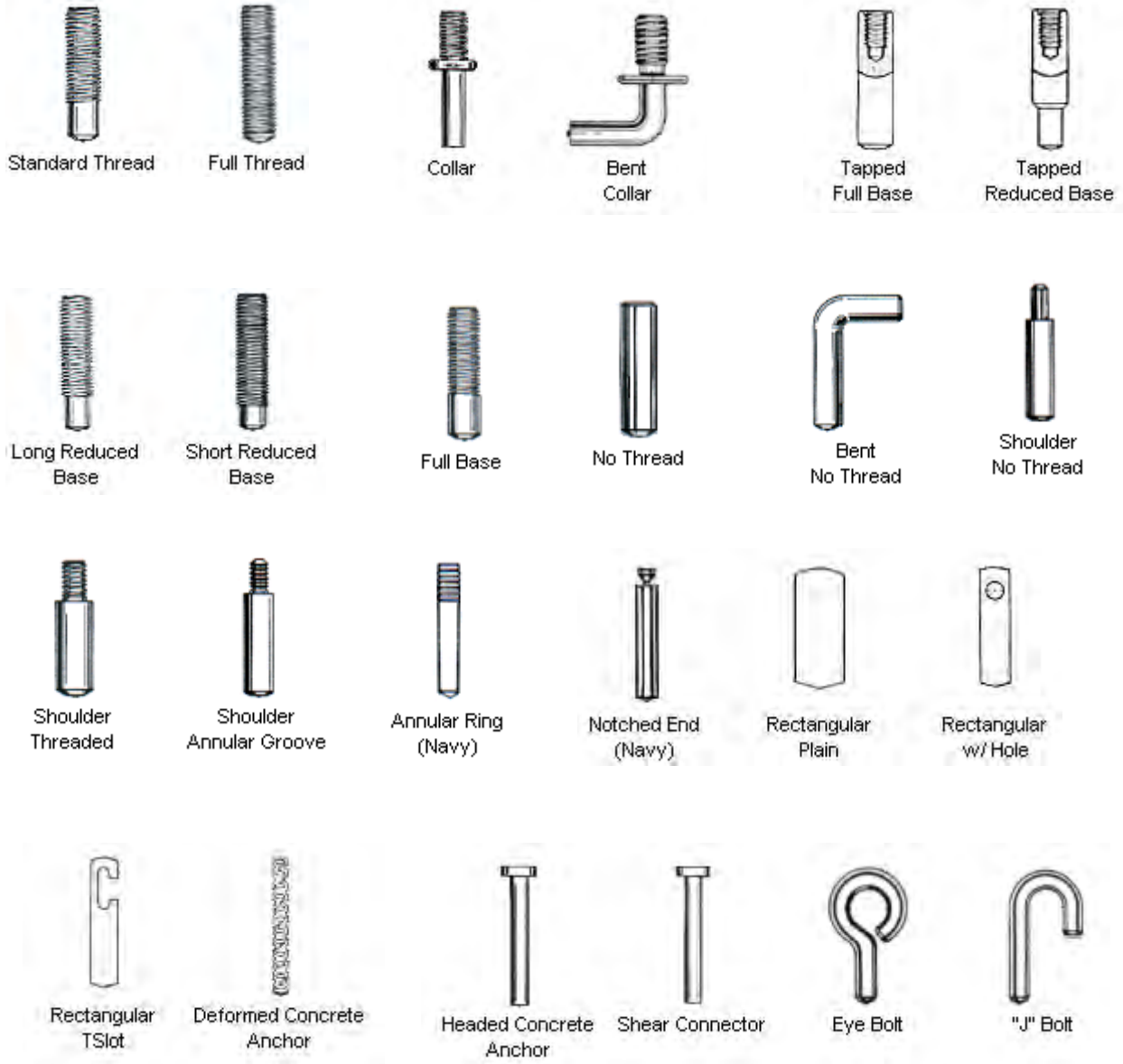

www.sunbeltstudwelding.com

Sunbelt Stud Welding, Inc.
6381 Windfern Road
Houston, Texas 77040-4915



1-800-462-9353
713-939-8903
fax 713-939-9013



ARC STUDS: STANDARD THREAD

To order or specify give:
 Product Code: **ARC ST** Diameter: Specify **D** Length: Specify **L** Material: Specify

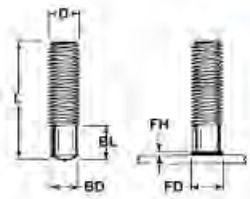

ARC STUD						
D	MIN L	BD	MIN BL	FD	FH	FERRULE CODE
1/4	3/4	.215	.375	.312	.093	P250
5/16	3/4	.275	.375	.406	.109	P312
3/8	3/4	.330	.390	.468	.109	P375
7/16	3/4	.387	.437	.531	.125	P437
1/2	7/8	.446	.500	.593	.156	P500
5/8	1	.562	.625	.750	.187	P625
3/4	1-1/4	.680	.796	.920	.250	P750
7/8	1-3/8	.798	.859	1.046	.312	P875
1"	1-1/2	.913	.921	1.187	.375	P1,000

MATERIAL	MILD STEEL C - 0.23% max. Mn - 0.90% max. P - 0.04% max. S - 0.05% max.	STAINLESS STEEL AISI grade - 302/304/305/316 std. Other grades available upon request.
	MECHANICAL PROPERTIES Tensile 60,000 psi (min.) Yield 50,000 psi (min.) Elongation..... 20% (in 2 inches)	Values for various grades available upon request.
PLATING	Plating is not standard. Cadmium, Copper, Nickel, and Zinc available upon customer request.	Does not apply to Stainless.

www.sunbeltstudwelding.com

Sunbelt Stud Welding, Inc.
 6381 Windfern Road
 Houston, Texas 77040-4915



1-800-462-9353
713-939-8903
 fax **713-939-9013**



ARC STUDS: FULL THREAD

To order or specify give:
 Product Code: **ARC FT** Diameter: Specify **D** Length: Specify **L** Material: Specify

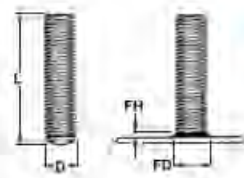

ARC STUD				
D	MIN L	FD	FH	FERRULE CODE
#10	3/4	.281	.093	F187
1/4	3/4	.359	.109	F250
5/16	3/4	.437	.109	F312
3/8	3/4	.500	.125	F375
7/16	7/8	.578	.140	F437
1/2	7/8	.625	.156	F500
5/8	1-1/8	.796	.187	F625
3/4	1-1/8	.937	.250	F750
7/8	1-1/2	1.093	.312	F875

Standard thread is UNC-2A (Rolled when possible). Other threads are available upon request. Maximum standard thread length is 3-7/8".

MATERIAL	MILD STEEL C - 0.23% max. Mn - 0.90% max. P - 0.04% max. S - 0.05% max.		STAINLESS STEEL AISI grade - 302/304/305/316 std. Other grades available upon request.
	MECHANICAL PROPERTIES	Tensile 60,000 psi (min.) Yield 50,000 psi (min.) Elongation..... 20% (in 2 inches)	Values for various grades available upon request.
PLATING	Plating is not standard. Cadmium, Copper, Nickel, and Zinc available upon customer request.	Does not apply to Stainless.	

www.sunbeltstudwelding.com

Sunbelt Stud Welding, Inc.
 6381 Windfern Road
 Houston, Texas 77040-4915



1-800-462-9353
713-939-8903
 fax **713-939-9013**



ARC STUDS: FULL BASE

To order or specify give:
 Product Code: **ARC FB** Diameter: Specify **D** Length: Specify **L** Material: Specify

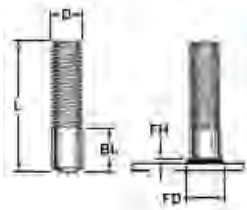

STUD					
D	MIN L	MIN BL	MAX FD	MAX FH	FERRULE CODE
1/4	3/4	.375	.335		F250
5/16	7/8	.375	.408	.125	F312
3/8		.500	.488	.141	F375
7/16	1-1/8	.500	.548	.158	F437
1/2	1-1/4	.500	.809	.172	F500
5/8	1-1/2	.500	.765	.268	F625
3/4	1-3/4	.675	.908	.335	F750
7/8	2-1/2	.750	1.048	.390	F875
1	2-1/2	1.000	1.203	.468	F1000

Standard thread is UNC-2A (Rolled when possible).
 Other threads are available upon request. Maximum standard thread length is 3-7/8".

MATERIAL	MILD STEEL C - 0.23% max. Mn - 0.60% max. P - 0.04% max. S - 0.05% max.	STAINLESS STEEL AISI grade - 302/304/305/316 std. Other grades available upon request.
MECHANICAL PROPERTIES	Tensile 60,000 psi (min.) Yield 50,000 psi (min.) Elongation..... 20% (in 2 inches)	Values for various grades available upon request.
PLATING	Plating is not standard. Cadmium, Copper, Nickel, and Zinc available upon customer request.	Does not apply to Stainless.

www.sunbeltstudwelding.com

Sunbelt Stud Welding, Inc.
 6381 Windfern Road
 Houston, Texas 77040-4915



9-5

1-800-462-9353
713-939-8903
 fax **713-939-9013**



ARC STUDS: LONG REDUCED BASE

To order or specify give:
 Product Code: **ARC** Diameter: Specify **D** Length: Specify **L** Material: Specify **LRB**

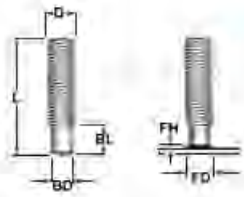

STUD						
D	MIN L	BD	MIN BL	FD	FH	FERRULE CODE
1/4	3/4	.187	.375	.281	.109	FS187
5/16	3/4	.250	.375	.369	.125	FS250
3/8	3/4	.312	.375	.437	.125	FS312
7/16	1	.375	.375	.500	.140	FS375
1/2	1	.437	.437	.578	.140	FS437
5/8	1-1/4	.500	.500	.656	.156	FS500
3/4	1-1/2	.625	.718			FS625

Standard thread is UNC-2A (Rolled when possible).
 Other threads are available upon request. Maximum standard thread length is 3-7/8".

MATERIAL	MILD STEEL	STAINLESS STEEL
	C - 0.23% max. Mn - 0.90% max. P - 0.04% max. S - 0.05% max.	AISI grade - 302/304/305/316 std. Other grades available upon request.
MECHANICAL PROPERTIES	Tensile	60,000 psi (min.)
	Yield	50,000 psi (min.)
	Elongation	20% (in 2 inches)
PLATING	Plating is not standard. Cadmium, Copper, Nickel, and Zinc available upon customer request.	Does not apply to Stainless.

www.sunbeltstudwelding.com

Sunbelt Stud Welding, Inc.
 6381 Windfern Road
 Houston, Texas 77040-4915



1-800-462-9353
713-939-8903
fax 713-939-9013



ARC STUDS: SHORT REDUCED BASE

To order or specify give:
 Product Code: **ARC** Diameter: Specify **D** Length: Specify **L** Material: Specify **SRB**

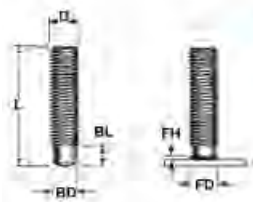

STUD						
D	MIN L	BD	MIN BL	FD	FH	FERRULE CODE
1/4	7/8	.187	.158	.281	.109	TB250
5/16	7/8	.275	.250	.390	.109	RB312
3/8	7/8	.312	.250	.437	.125	RB375
1/2	1	.435	.250	.593	.158	RB500
5/8	1-1/8	.500	.312	.887	.158	TB625
3/4	1-1/8	.625	.375	.812	.187	TB750

Standard thread is UNC-2A (Rolled when possible).
 Other threads are available upon request. Maximum standard thread length is 3-7/8".

MATERIAL	MILD STEEL C - 0.23% max. P - 0.04% max. Mn - 0.90% max. S - 0.05% max.	STAINLESS STEEL AISI grade - 302/304/305/316 std. Other grades available upon request.
MECHANICAL PROPERTIES	Tensile 80,000 psi (min.) Yield 50,000 psi (min.) Elongation..... 20% (in 2 inches)	Values for various grades available upon request.
PLATING	Plating is not standard. Cadmium, Copper, Nickel, and Zinc available upon customer request.	Does not apply to Stainless.

www.sunbeltstudwelding.com

Sunbelt Stud Welding, Inc.
 6381 Windfern Road
 Houston, Texas 77040-4915



9-7

1-800-462-9353
713-939-8903
fax 713-939-9013



ARC STUDS: NO THREAD

To order or specify give:
 Product Code: Diameter: Specify Length: Specify Material: Specify
ARC NT D L Material: Specify

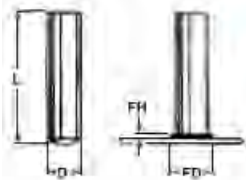

STUD				
D	MIN L	FD	FH	FERRULE CODE
3/16	3/4	.281	.093	F187
1/4	3/4	.359	.109	F250
5/16	3/4	.437	.109	F312
3/8	3/4	.500	.125	F375
7/16	3/4	.578	.140	F437
1/2	7/8	.627	.156	F500
5/8	1"	.796	.187	F625
3/4	1-1/8	.937	.250	F750
7/8	1-1/4	1.093	.312	F875
1"	1-1/2	1.312	.375	F1,000

* Ferrules used with Studs 3/4" long are special "short F" ferrules. **KNOCK-OFF studs are available if shorter lengths are required.

MATERIAL	MILD STEEL C - 0.23% max. Mn - 0.90% max. P - 0.04% max. S - 0.05% max.	STAINLESS STEEL AISI grade - 302/304/305/316 std. Other grades available upon request.
MECHANICAL PROPERTIES	Tensile 60,000 psi (min.) Yield 50,000 psi (min.) Elongation..... 20% (in 2 inches)	Values for various grades available upon request.
PLATING	Plating is not standard. Cadmium, Copper, Nickel, and Zinc available upon customer request.	Does not apply to Stainless.

www.sunbeltstudwelding.com

Sunbelt Stud Welding, Inc.
 6381 Windfern Road
 Houston, Texas 77040-4915



1-800-462-9353
713-939-8903
fax 713-939-9013



ARC STUDS: BENT NO THREAD

To order or specify give:
 Product Code: **ARC** Diameter: Specify **D** Length: Specify **L** Material: Specify **B-NT**

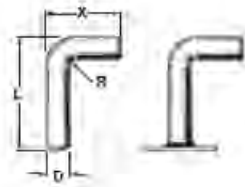

STUD				
D	MIN L	MIN X	MIN R	FERRULE CODE
1/4	1-1/8	1-1/4	.125	F250
5/16	1-1/4	1-1/2	.218	F312
3/8	1-1/2	1-1/2	.218	F375
7/16	1-5/8	1-5/8	.250	F437
1/2	1-3/4	1-3/4	.250	F500
5/8	1-7/8	2"	.312	F625
3/4	2-3/4	3"	.500	F750
7/8	3-1/2	3-3/8	.500	F875

MATERIAL	MILD STEEL	STAINLESS STEEL
	C - 0.23% max. Mn - 0.90% max.	P - 0.04% max. S - 0.05% max.
		AISI grade - 302/304/305/316 std. Other grades available upon request.
MECHANICAL PROPERTIES	Tensile 60,000 psi (min.) Yield 50,000 psi (min.) Elongation..... 20% (in 2 inches)	Values for various grades available upon request.
PLATING	Plating is not standard. Cadmium, Copper, Nickel, and Zinc available upon customer request.	Does not apply to Stainless.

www.sunbeltstudwelding.com

Sunbelt Stud Welding, Inc.
 6381 Windfern Road
 Houston, Texas 77040-4915



1-800-462-9353
713-939-8903
 fax **713-939-9013**



ARC STUDS: TAPPED FULL BASE

To order or specify give:
 Product Code: Diameter: Length: Tap Diameter: Tap Length: Material:
ARC TAPFB Specify **D** Specify **L** Specify **TD** Specify **TL** Specify

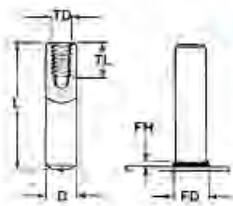

STUD						
D	MIN L	TD	TL*	MAX FD	MAX FH	FERRULE CODE
1/4	9/16	8-32	1/4	.358	.108	F250
5/16	21/32	10-24	9/32	.437	.109	F312
3/8	13/16	1/4-20	3/8	.500	.125	F375
7/16	29/32	5/16-18	15/32	.578	.140	F437
1/2	1-1/32	3/8-18	9/16	.625	.156	F500
5/8	1-9/32	7/16-14	21/32	.796	.187	F625
3/4	1-3/8	1/2-13	3/4	.937	.250	F750
7/8	1-5/8	5/8-11	15/16	1.093	.312	F875

* Maximum standard tap depth equals 1-1/2 times tap diameter. **TAPS:** Standard tap is UNC-2B, other taps are available.

MATERIAL	MILD STEEL C - 0.23% max. Mn - 0.90% max. P - 0.04% max. S - 0.05% max.	STAINLESS STEEL AISI grade - 302/304/305/316 std. Other grades available upon request.
MECHANICAL PROPERTIES	Tensile 60,000 psi (min.) Yield 50,000 psi (min.) Elongation..... 20% (in 2 inches)	Values for various grades available upon request.
PLATING	Plating is not standard. Cadmium, Copper, Nickel, and Zinc available upon customer request.	Does not apply to Stainless.

www.sunbeltstudwelding.com

Sunbelt Stud Welding, Inc.
 6381 Windfern Road
 Houston, Texas 77040-4915



1-800-462-9353
713-939-8903
fax 713-939-9013



**ARC STUDS: TAPPED
REDUCED BASE**

To order or specify give:

Product Code:	Base Diameter:	Base Length:	Thread Diameter:	Thread Length:	Material:
ARC	Specify BD	Specify BL	Specify TD	Specify TL	Specify
TAPRB					

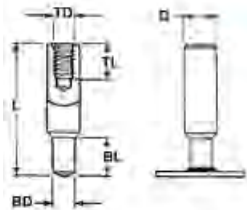

STUD						
D	MIN L	TD	TL*	BD	BL	FERRULE CODE
3/8	1-1/2	1/4-20	3/8	.250	7/16	FS250
1/2	1-1/2	3/8-16	9/16	.375	7/16	FS375
5/8	1-1/2	7/16-14	21/32	.500	1/2	FS500
3/4	1-1/2	1/2-13	3/4	.500	1/2	FS500
7/8	2	5/8-11	15/16	.625	5/8	FS625
1"	2-1/2	3/4-10	1"	.750	5/8	FS750

* Maximum standard tap depth equals 1-1/2 times tap diameter. **TAPS:** Standard tap is UNC-2B, other taps are available.

MATERIAL	MILD STEEL		STAINLESS STEEL
	C - 0.23% max. Mn - 0.90% max.	P - 0.04% max. S - 0.05% max.	AISI grade - 302/304/305/316 std. Other grades available upon request.
MECHANICAL PROPERTIES	Tensile	75,000 psi (min.)	Values for various grades available upon request.
	Yield	64,000 psi (min.)	
	Elongation	20% (in 2 inches)	
PLATING	Plating is not standard. Cadmium, Copper, Nickel, and Zinc available upon customer request.		Does not apply to Stainless.

www.sunbeltstudwelding.com

Sunbelt Stud Welding, Inc.
6381 Windfern Road
Houston, Texas 77040-4915



9-11

1-800-462-9353
713-939-8903
fax 713-939-9013



ARC STUDS: SHOULDER THREADED

To order or specify give:

Product	Diameter:	Length:	Thread	Thread	Material:
Code:	Specify D	Specify L	Dia.:	Length:	Specify
ARC SH-T			Specify TD	Specify TL	

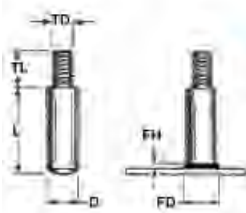

STUD						
D	MIN L	TD	MAX TL	FD	FH	FERRULE CODE
1/4	.312	#8	.437	.358	.109	F250
5/16	.375	#10	.500	.437	.109	F312
3/8	.375	1/4	.750	.500	.125	F375
7/16	.437	5/16	.875	.578	.140	F437
1/2	.500	3/8	1.000	.627	.156	F500
5/8	.625	1/2	1.250	.796	.187	F625
3/4	.625	5/8	1.625	.937	.250	F750
7/8	.750	3/4	1.875	1.093	.312	F875

THREADS: Standard thread is UNC-2A (Rolled when possible), other threads are available upon request.

MATERIAL	MILD STEEL C - 0.23% max. Mn - 0.90% max. P - 0.04% max. S - 0.05% max.	STAINLESS STEEL AISI grade - 302/304/305/316 std. Other grades available upon request.
MECHANICAL PROPERTIES	Tensile 60,000 psi (min.) Yield 50,000 psi (min.) Elongation..... 20% (in 2 inches)	Values for various grades available upon request.
PLATING	Plating is not standard. Cadmium, Copper, Nickel, and Zinc available upon customer request.	Does not apply to Stainless.

www.sunbeltstudwelding.com

Sunbelt Stud Welding, Inc.
 6381 Windfern Road
 Houston, Texas 77040-4915



1-800-462-9353
713-939-8903
fax 713-939-9013



ARC STUDS: SHOULDER ANNULAR GROOVE

To order or specify give:
 Product Code: Diameter: Length: Groove Dia.: Groove Len.: Material:
ARC SH-AG Specify **D** Specify **L** Specify **GD** Specify **GL** Specify

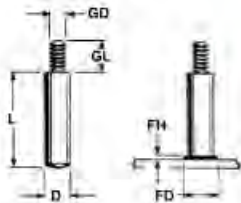

STUD						
D	MIN L	GD	GL	FD	FH	FERRULE CODE
5/16	1"	.187	.375	.437	.109	F312
5/16	1"	.187	.437	.437	.109	F312

MATERIAL	MILD STEEL C - 0.23% max. Mn - 0.90% max. P - 0.04% max. S - 0.05% max.	STAINLESS STEEL AISI grade - 302/304/305/316 std. Other grades available upon request.
MECHANICAL PROPERTIES	Tensile 60,000 psi (min.) Yield 50,000 psi (min.) Elongation..... 20% (in 2 inches)	Values for various grades available upon request.
PLATING	Plating is not standard. Cadmium, Copper, Nickel, and Zinc available upon customer request.	Does not apply to Stainless.

Annular Groove Cap (for annular groove shoulder studs)

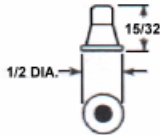

Part No.
102 0100 08

CAP: Sold separately. Not a component part of stud.

APPLICATION	Designed to permanently lock on to annular groove shoulder studs to hold panel in place against stud shoulder.
MATERIAL	Aluminum
SIZE	For 3/16" diameter annular groove.

www.sunbeltstudwelding.com

Sunbelt Stud Welding, Inc.
 6381 Windfern Road
 Houston, Texas 77040-4915



9-13

1-800-462-9353
713-939-8903
fax 713-939-9013



ARC STUDS: SHOULDER NO THREAD

To order or specify give:
 Product Code: Diameter: Length: Ext. Dia.: Ext. Length: Material:
ARC SH-NT Specify **D** Specify **L** Specify **ED** Specify **EL** Specify

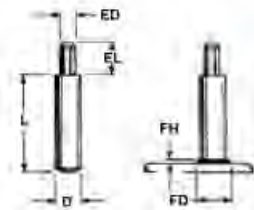

STUD						
D	MIN L	ED	EL	FD	FH	FERRULE CODE
5/16	3/8	3/16	3/16	.437	.109	F312
3/8	3/8	3/16	3/16	.500	.125	F375
1/2	1/2	3/8	45/64	.627	.156	F500

MATERIAL	MILD STEEL		STAINLESS STEEL
	C - 0.23% max. Mn - 0.90% max.	P - 0.04% max. S - 0.05% max.	AISI grade - 302/304/305/316 std. Other grades available upon request.
MECHANICAL PROPERTIES	Tensile	60,000 psi (min.)	Values for various grades available upon request.
	Yield	50,000 psi (min.)	
	Elongation.....	20% (in 2 inches)	
PLATING	Plating is not standard. Cadmium, Copper, Nickel, and Zinc available upon customer request.		Does not apply to Stainless.

www.sunbeltstudwelding.com

Sunbelt Stud Welding, Inc.
 6381 Windfern Road
 Houston, Texas 77040-4915



1-800-462-9353
713-939-8903
 fax **713-939-9013**



ARC STUDS: COLLAR

To order or specify give:

Product Code:	Base Diameter:	Base Length:	Thread Diameter:	Thread Length:	Material:
ARC COL	Specify BD	Specify BL	Specify TD	Specify TL	Specify

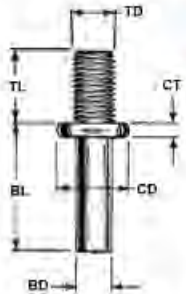

STUD						
D	MIN TL	BD	MIN BL	CD	CT	FERRULE CODE
1/4	.375	.215	.500	.500	.093	C250
5/16	.375	.275	.500	.562	.093	C312
3/8	.500	.330	.500	.625	.109	C375
1/2	.625	.448	.593	.750	.140	C500

THREADS: Standard thread is UNC-2A (Rolled when possible), other threads are available upon request.

MATERIAL	MILD STEEL		STAINLESS STEEL
	C - 0.23% max. Mn - 0.90% max.	P - 0.04% max. S - 0.05% max.	AISI grade - 302/304/305/316 std. Other grades available upon request.
MECHANICAL PROPERTIES	Tensile	60,000 psi (min.)	Values for various grades available upon request.
	Yield	50,000 psi (min.)	
	Elongation	20% (in 2 inches)	
PLATING	Plating is not standard. Cadmium, Copper, Nickel, and Zinc available upon customer request.		Does not apply to Stainless.

www.sunbeltstudwelding.com

Sunbelt Stud Welding, Inc.
 6381 Windfern Road
 Houston, Texas 77040-4915



1-800-462-9353
713-939-8903
 fax **713-939-9013**



ARC STUDS: BENT COLLAR

To order or specify give:

Product Code:	Base Diameter:	Base Length:	Thread Diameter:	Thread Length:	Material: Specify
ARC B-COL	Specify BD	Specify BL	Specify TD	Specify TL	

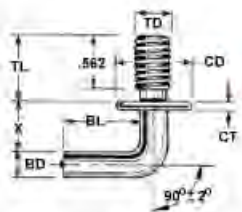

STUD						
D	STD. TL	BD	MIN BL	CD	CT	X
3/8-16	1.375	.331	.625	5/8	.109	5/8

THREADS: Standard thread is UNC-2A (Rolled when possible), other threads are available upon request.

MATERIAL	MILD STEEL		STAINLESS STEEL
	C - 0.23% max.	P - 0.04% max.	AISI grade - 302/304/305/316 std. Other grades available upon request.
MECHANICAL PROPERTIES	Tensile	60,000 psi (min.)	Values for various grades available upon request.
	Yield	50,000 psi (min.)	
	Elongation	20% (in 2 inches)	
PLATING	Plating is not standard. Cadmium, Copper, Nickel, and Zinc available upon customer request.		Does not apply to Stainless.

www.sunbeltstudwelding.com

Sunbelt Stud Welding, Inc.
 6381 Windfern Road
 Houston, Texas 77040-4915



1-800-462-9353
713-939-8903
fax 713-939-9013



ARC STUDS: ANNULAR RING NAVY

To order or specify give:
 Product Code: **ARC AR** Diameter: Specify **D** Length: Specify **L** Material: Specify

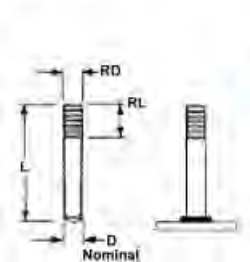

STUD				
NOM D	MIN L	RD	RL	FERRULE CODE
3/16	3/4**	.175	.312	F187

* Ferrules used with Studs 3/4" long are special "short F" ferrules.

MATERIAL	MILD STEEL C - 0.23% max. P - 0.04% max. Mn - 0.90% max. S - 0.05% max.	STAINLESS STEEL AISI grade - 302/304/305/316 std. Other grades available upon request.
MECHANICAL PROPERTIES	Tensile 60,000 psi (min.) Yield 50,000 psi (min.) Elongation..... 20% (in 2 inches)	Values for various grades available upon request.
PLATING	Plating is not standard. Cadmium, Copper, Nickel, and Zinc available upon customer request.	Does not apply to Stainless.

Annular Ring Cap (for annular ring studs)

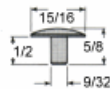

Cap Part No.
052-297

CAP: Sold separately. Not a component part of stud.

APPLICATION	Designed to permanently lock on to Navy annular ring studs.
MATERIAL	Aluminum
SIZE	For 1/8" or 3/16" diameter studs.

www.sunbeltstudwelding.com

Sunbelt Stud Welding, Inc.
 6381 Windfern Road
 Houston, Texas 77040-4915





ARC STUDS: NOTCHED END NAVY

To order or specify give:
 Product Code: **ARC NE** Diameter: Specify **D** Length: Specify **L** Material: Specify

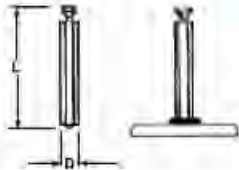

STUD		
D	MIN L	FERRULE CODE
3/16	3/4**	F187

* Ferrules used with Studs 3/4" long are special "short F" ferrules.

MATERIAL	MILD STEEL C - 0.23% max. Mn - 0.90% max. P - 0.04% max. S - 0.05% max.	STAINLESS STEEL AISI grade - 302/304/305/316 std. Other grades available upon request.
MECHANICAL PROPERTIES	Tensile 60,000 psi (min.) Yield 50,000 psi (min.) Elongation..... 20% (in 2 inches)	Values for various grades available upon request.
PLATING	Plating is not standard. Cadmium, Copper, Nickel, and Zinc available upon customer request.	Does not apply to Stainless.

Key Hole Slotted Washer (For 3/16 dia. notched end studs)



Key Hole Slotted Washer
 Part No.
 033 1000 45 (Galvanized)
 033 1000 46 (Cadmium Plated)

APPLICATION	Designed to lock on to Navy notched end studs.
MATERIAL	Mild Steel - Cadmium Plated Mild Steel - Galvanized

www.sunbeltstudwelding.com

Sunbelt Stud Welding, Inc.
 6381 Windfern Road
 Houston, Texas 77040-4915



1-800-462-9353
713-939-8903
fax 713-939-9013



ARC STUDS: RECTANGULAR PLAIN

To order or specify give:
 Product Code: **ARC R-** Size: **1/8** x Length: Specify **L** Material: Specify
PL **W**

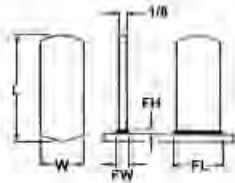

STUD					
W	MIN L	FW	FL	FH	FERRULE CODE
3/8	7/8	.218	.437	.125	R375
5/8	1"	.218	.687	.156	R625

MATERIAL	MILD STEEL C - 0.23% max. Mn - 0.90% max. P - 0.04% max. S - 0.05% max.	STAINLESS STEEL AISI grade - 302/304/305/316 std. Other grades available upon request.
MECHANICAL PROPERTIES	Tensile 80,000 psi (min.) Yield 50,000 psi (min.) Elongation..... 20% (in 2 inches)	Values for various grades available upon request.
PLATING	Plating is not standard. Cadmium, Copper, Nickel, and Zinc available upon customer request.	Does not apply to Stainless.

www.sunbeltstudwelding.com

Sunbelt Stud Welding, Inc.
 6381 Windfern Road
 Houston, Texas 77040-4915



1-800-462-9353
713-939-8903
fax 713-939-9013



**ARC STUDS:
RECTANGULAR W/HOLE**

To order or specify give:
 Product Code: **ARC R-** Size: **1/8** x Length: Specify Material: Specify
WH **W** **L**

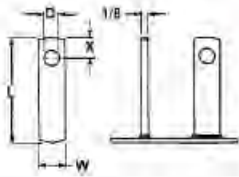

STUD				
W	MIN L	D	X	FERRULE CODE
3/8	7/8	.203	5/16	R375
5/8	1"	.312	5/16	R625

MATERIAL	MILD STEEL C - 0.23% max. Mn - 0.90% max. P - 0.04% max. S - 0.05% max.	STAINLESS STEEL AISI grade - 302/304/305/316 std. Other grades available upon request.
MECHANICAL PROPERTIES	Tensile 80,000 psi (min.) Yield 50,000 psi (min.) Elongation..... 20% (in 2 inches)	Values for various grades available upon request.
PLATING	Plating is not standard. Cadmium, Copper, Nickel, and Zinc available upon customer request.	Does not apply to Stainless.

www.sunbeltstudwelding.com

Sunbelt Stud Welding, Inc.
 6381 Windfern Road
 Houston, Texas 77040-4915



1-800-462-9353
 713-939-8903
 fax 713-939-9013



ARC STUDS: RECTANGULAR T-SLOT

To order or specify give:
 Product Code: **ARC R-** Size: **1/8** x Length: Specify Material: Specify
TS **W** **L**

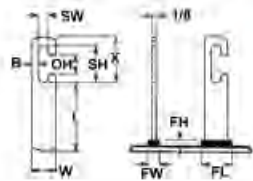

STUD					
W	MIN L	OH	SH	X	SW
3/8	1/2	.322	.531	.785	.130
5/8	1/2	.500	1.000	1.250	.255

STUD (Continued)				
B	FW	FL	FH	FERRULE CODE
.122	.218	.437	.125	R375
.185	.218	.687	.158	R825

MATERIAL	MILD STEEL C - 0.23% max. Mn - 0.90% max. P - 0.04% max. S - 0.05% max.	STAINLESS STEEL AISI grade - 302/304/305/316 std. Other grades available upon request.
MECHANICAL PROPERTIES	Tensile 60,000 psi (min.) Yield 50,000 psi (min.) Elongation..... 20% (in 2 inches)	Values for various grades available upon request.
PLATING	Plating is not standard. Cadmium, Copper, Nickel, and Zinc available upon customer request.	Does not apply to Stainless.

www.sunbeltstudwelding.com

Sunbelt Stud Welding, Inc.
 6381 Windfern Road
 Houston, Texas 77040-4915



9-21

1-800-462-9353
713-939-8903
 fax **713-939-9013**



**ARC STUDS: DEFORMED
CONCRETE ANCHOR**

To order or specify give:
 Product Code: **ARC-DCA** Diameter: Specify **D** Length: Specify **L** Material: Specify

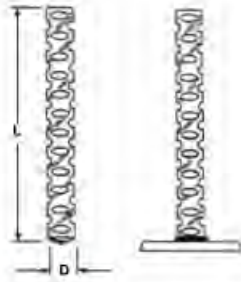

STUD		
D	MIN L	FERRULE CODE
1/4	3/4	F250
3/8	3/4	F375
1/2	1"	F500
5/8	1"	F625

MATERIAL	MILD STEEL	
	C - 0.23% max.	P - 0.04% max.
	Mn - 0.90% max.	S - 0.05% max.
MECHANICAL PROPERTIES	Tensile	80,000 psi (min.)
	Yield	70,000 psi (min.)

www.sunbeltstudwelding.com

Sunbelt Stud Welding, Inc.
 6381 Windfern Road
 Houston, Texas 77040-4915



1-800-462-9353
713-939-8903
fax 713-939-9013



ARC STUDS: HEADED CONCRETE ANCHOR

To order or specify give:
 Product Code: Diameter: Specify Length: Specify Material: Specify
ARC- HCA **D** **L**

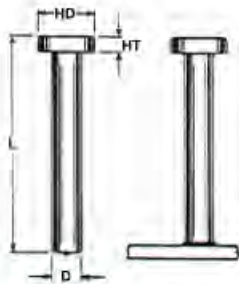

STUD				
D	MIN L	HD	HT	FERRULE CODE
1/4	3/4	1/2	3/16	F250
3/8	3/4	3/4	9/32	F375
1/2	1"	1"	5/16	F500
5/8	1"	1-1/4	5/16	F625

MATERIAL	MILD STEEL AISI C1010 through C1020			
MECHANICAL PROPERTIES	Tensile	55,000 psi (min.)	
	Elongation	20% (in 2 inches)	



Headed Concrete Anchors are available for welding to flat surfaces, inside angles, and outside angles. Each of these applications requires the proper style stud and ferrule, so please specify your application when ordering.

www.sunbeltstudwelding.com

Sunbelt Stud Welding, Inc.
6381 Windfern Road
Houston, Texas 77040-4915



1-800-462-9353
713-939-8903
fax 713-939-9013



ARC STUDS: SHEAR CONNECTOR

To order or specify give:
 Product Code: **ARC SC** Diameter: Specify **D** Length: Specify **L** Material: Specify

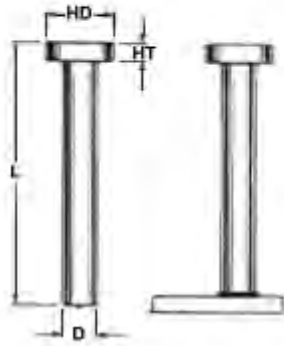

STUD				
D	MIN L	HD	HT	FERRULE CODE
3/4	1-1/2	1-1/4	3/8	F750
7/8	2	1-3/8	3/8	F875

MATERIAL	MILD STEEL AISI C1015, C1018 or C1020	
MECHANICAL PROPERTIES	Tensile 60,000 psi (min.) Yield 50,000 psi (min.) Elongation 20% (min.) Area 50% (min.)	Values for various grades available upon request.

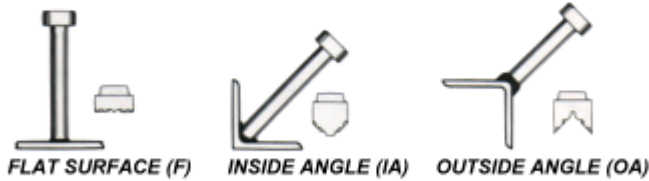

Headed Concrete Anchors are available for welding to flat surfaces, inside angles, and outside angles. Each of these applications requires the proper style stud and ferrule, so please specify your application when ordering.

www.sunbeltstudwelding.com

Sunbelt Stud Welding, Inc.
 6381 Windfern Road
 Houston, Texas 77040-4915



1-800-462-9353
713-939-8903
 fax **713-939-9013**



ARC STUDS: EYEBOLT

To order or specify give:
 Product Diameter: Length: Eye Dia.: Gap: Material:
 Code: **ARC EB** Specify **D** Specify **L** Specify **ID** Specify **G** Specify

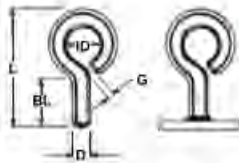

STUD					
D	MIN L	MIN BL	MIN ID	MIN G	FERRULE CODE
3/16	1-7/8	3/4	1/2	3/16	F187
1/4	1-3/4	3/4	3/4	1/4	F250
5/16	1-7/8	3/4	3/4	5/16	F312
3/8	2-5/8	1	7/8	3/8	F375
7/16	3	1-1/8	1	7/16	F437
1/2	3-5/8	1-3/8	1-1/4	1/2	F500

MATERIAL	MILD STEEL C - 0.23% max. Mn - 0.80% max. P - 0.04% max. S - 0.05% max.	STAINLESS STEEL AISI grade - 302/304/305/316 std. Other grades available upon request.
MECHANICAL PROPERTIES	Tensile 80,000 psi (min.) Yield 50,000 psi (min.) Elongation..... 20% (in 2 inches)	Values for various grades available upon request.
PLATING	Plating is not standard, Cadmium, Copper, Nickel, and Zinc available upon customer request.	Does not apply to Stainless.

www.sunbeltstudwelding.com

Sunbelt Stud Welding, Inc.
 6381 Windfern Road
 Houston, Texas 77040-4915



9-25

1-800-462-9353
713-939-8903
 fax **713-939-9013**



ARC STUDS: "J" BOLT

To order or specify give:
 Product Size: Length: J Diameter: Extension: Material:
 Code: **ARC JB** Specify **D** Specify **L** Specify **ID** Specify **E** Specify

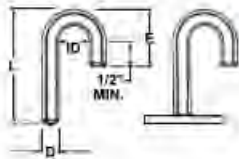

STUD				
D	MIN L	MIN ID	MIN E	FERRULE CODE
3/16	1-1/8	1/2	1	F187
1/4	1-1/4	5/8	1-1/8	F250
5/16	1-1/2	3/4	1-1/4	F312
3/8	1-5/8	7/8	1-3/8	F375
7/16	1-3/4	1	1-1/2	F437
1/2	2	1	1-1/2	F500
5/8	2-1/2	1-1/2	1-7/8	F625

MATERIAL	MILD STEEL	STAINLESS STEEL	
	C - 0.23% max. Mn - 0.90% max.	P - 0.04% max. S - 0.05% max.	AISI grade - 302/304/305/316 std. Other grades available upon request.
MECHANICAL PROPERTIES	Tensile	60,000 psi (min.)	Values for various grades available upon request.
	Yield	50,000 psi (min.)	
	Elongation	20% (in 2 inches)	
PLATING	Plating is not standard. Cadmium, Copper, Nickel, and Zinc available upon customer request.	Does not apply to Stainless.	

www.sunbeltstudwelding.com

Sunbelt Stud Welding, Inc.
 6381 Windfern Road
 Houston, Texas 77040-4915



1-800-462-9353
713-939-8903
 fax **713-939-9013**