

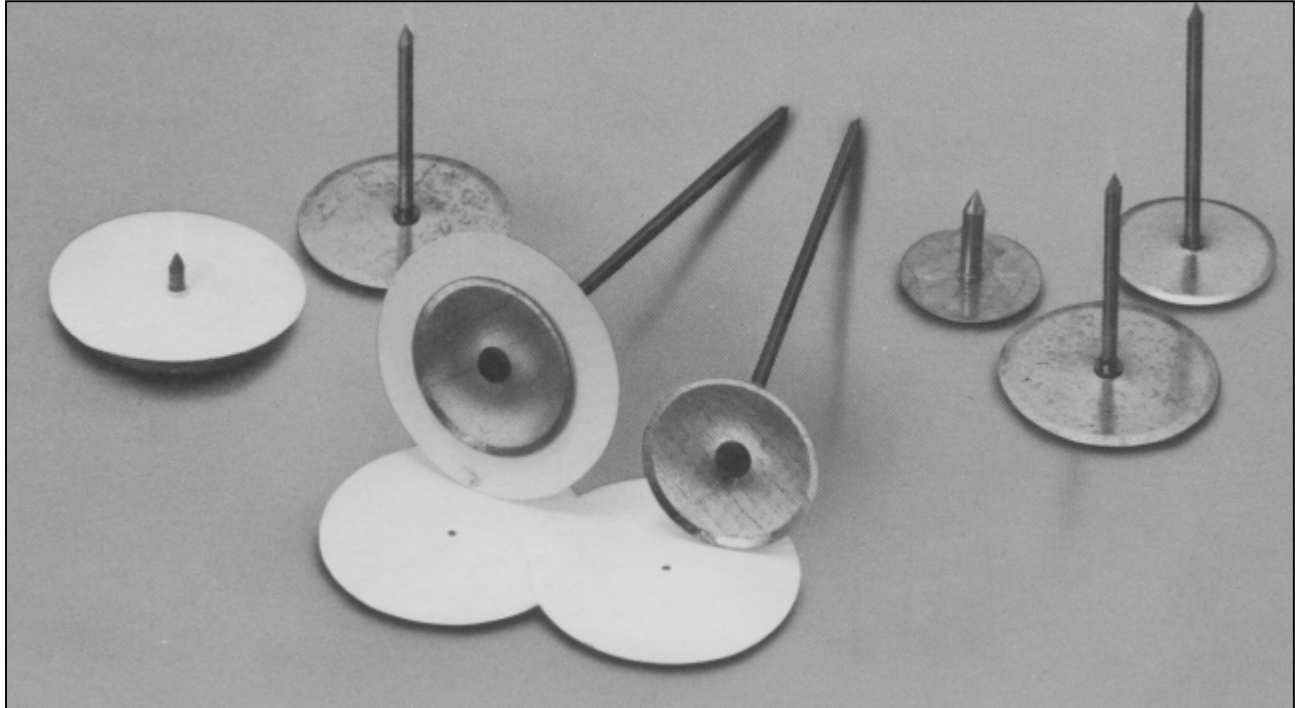

CUP HEAD PINS



SUNBELT Cup Head Pins simplify the permanent installation of duct liner or similar insulation to ducting and other HVAC sheet metals and housings. They can be applied quickly and easily using standard inductive CD stud welding equipment or resistance welding equipment.

SUNBELT Cup Head Pins are available in several different styles for portable inductive CD stud welders, which allow on-site insulating of ducting and other HVAC enclosures. There is also a style available for automatic resistance welders and pinspotters for the prefabrication of insulated ducting, panels or housings.

SUNBELT Cup Head Pins are normally available in the following:

MATERIALS: Washer – Mild Steel – Galvanized
Pin – Mild Steel – Copper Coated

SIZES: CS Washer – 1 3/16” diameter **LENGTHS:** in 1/8” increments from 3/8” to
CL Washer – 1 1/2” diameter 2 1/8”, and 1/2” increments from
Pin - 12 GA and 14 GA are standard 2 1/2” to 6” are standard.

SUNBELT Cup Head Pins can also be purchased with Paper Insulating Washers attached to avoid damaging arcing when welding through foil faced insulation.

www.sunbeltstudwelding.com

Sunbelt Stud Welding, Inc.
6381 Windfern Road
Houston, Texas 77040-4915



2-1

1-800-462-9353
713-939-8903
fax 713-939-9013



CUP HEAD PIN - APPLICATION

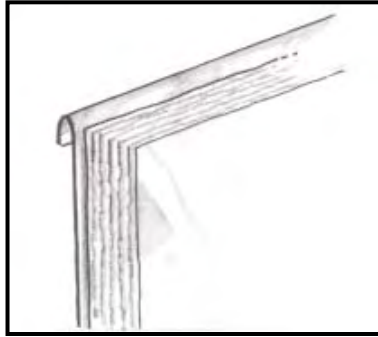

1. HANG INSULATION

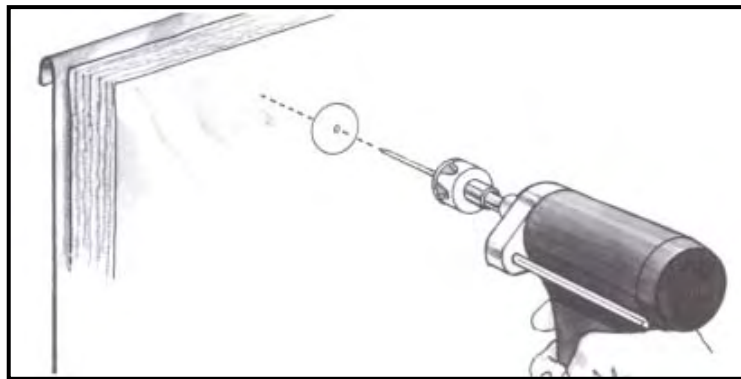

2. PRESS CUPHEAD PIN THROUGH INSULATION.

Note: an insulating paper washer is required here when welding through foil faced insulation.

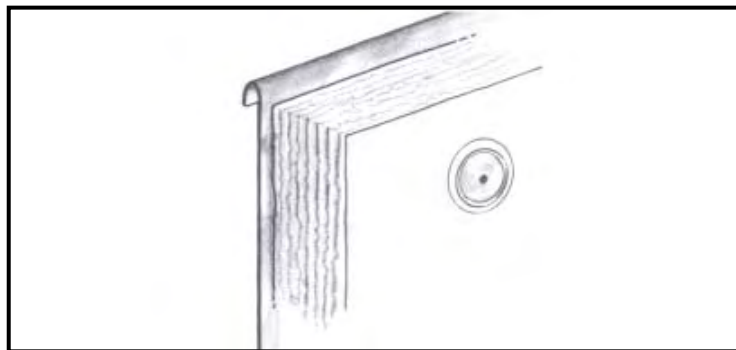

3. WELD IN PLACE TO COMPLETE INSTALLATION

www.sunbeltstudwelding.com

Sunbelt Stud Welding, Inc.
6381 Windfern Road
Houston, Texas 77040-4915



1-800-462-9353
713-939-8903
fax 713-939-9013



CUP HEAD PIN (CD)

To order or specify give:
 Product Code: **CHP** Diameter: Specify Length: Specify **L** Material: Specify

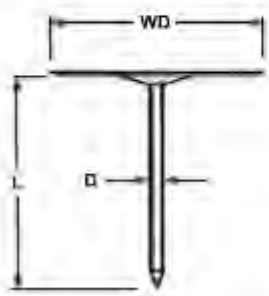

<i>PRODUCT</i>				
TYPE	D	WD	MIN L	MAX L
CL 10	.135	1.500	3/8	NO MAX.
CL 12	.105	1.500	3/8	NO MAX.
CS 12	.105	1.187	3/8	NO MAX.
CS 14	.080	1.187	3/16	2"

	<i>PIN</i>	<i>WASHER</i>
MATERIALS	LOW CARBON STEEL C - .23% max. P - .04% max. Mn - 0.90% max. S - 0.05% max.	LOW CARBON STEEL C - .23% max. P - .04% max. Mn - 0.90% max. S - 0.05% max.
MECHANICAL PROPERTIES	Values available upon request.	Values available upon request.
PLATING	Standard Pin is Galvanized Copper Plating is available	Standard Washer is Galvanized
BEVEL		Washer edge is beveled to prevent cutting of insulation material.
STAINLESS STEEL		Not standard, but available by special order.
PAPER INSULATING WASHERS		Available, upon request, for welding through foil faced insulation.

www.sunbeltstudwelding.com

Sunbelt Stud Welding, Inc.
 6381 Windfern Road
 Houston, Texas 77040-4915



1-800-462-9353
713-939-8903
fax 713-939-9013



CUP HEAD PINS – CS-10

To order or specify give:
 Product Code: **CHP CS-10** Diameter: Specify Length: Specify **L** Material: Specify

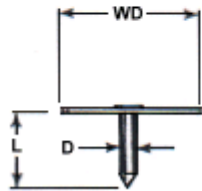

<i>PRODUCT</i>			
TYPE	D	WD	MIN L
CS 10	.135	1.000	3/8

	<i>PIN</i>	<i>WASHER</i>
MATERIALS	LOW CARBON STEEL C - .23% max. P - .04% max. Mn - 0.90% max. S - 0.05% max.	LOW CARBON STEEL C - .23% max. P - .04% max. Mn - 0.90% max. S - 0.05% max.
MECHANICAL PROPERTIES	Values available upon request.	Values available upon request.
PLATING	Standard Pin is Galvanized	Standard Washer is Galvanized

APPLICATION This cup head pin is for use with DuroDyne auto feed welding resistance equipment.

www.sunbeltstudwelding.com

Sunbelt Stud Welding, Inc.
 6381 Windfern Road
 Houston, Texas 77040-4915



1-800-462-9353
713-939-8903
 fax **713-939-9013**