



SECTION 13

ACCESSORY OPTIONS & DETAILS

FOR INQUIRIES, TO PLACE ORDERS,
SERVICE AND TECHNICAL SUPPORT CONTACT
ANY OF THE FOLLOWING:

OFFICE: 1-800-462-9353
713-939-8903

EMAIL: INFO@SUNBELTSTUDWELDING.COM



website www.sunbeltstudwelding.com **email** info@sunbeltstudwelding.com
6381 Windfern Road, Houston, TX 77040 **telephone** 1.800.462.9353 - Houston 713.939.8903 **fax** 713.939.9013

Accessories

FERRULE GRIP – TECHNICAL DETAILS

Closed Ferrule Grips (1" Long) Brass

Stud Size	Foot Size	Grip Dia. "D"	Part #
3/16	Small	0.305	GN-019
1/4	Small	0.380	GN-025
5/16	Small	0.445	GN-031
3/8	Small	0.505	GN-037
7/16	Small	0.585	GN-043
1/2	Small	0.650	GN-050
5/8	Medium	0.785	GN-062
3/4	Medium	1.030	GN-075
7/8	Large	1.203	GN-087
1"	Large	1.406	GN-100



Split Ferrule Grip (1" Long) BRASS

Stud Size	Foot Size	Grip Dia. "D"	Part #
3/16	Small	0.305	GC-019
1/4	Small	0.380	GC-025
5/16	Small	0.445	GC-031
3/8	Small	0.505	GC-037
7/16	Small	0.585	GC-043
1/2	Small	0.650	GC-050
5/8	Medium	0.785	GC-062
3/4	Medium	1.030	GC-075
7/8	Large	1.203	GC-087
1"	Large	1.406	GC-100



Long Split Ferrule Grip (2" Long) Brass

Stud Size	Foot Size	Grip Dia. "D"	Part #
3/16	Small	0.305	GC-019
1/4	Small	0.380	GC-025
5/16	Small	0.445	GC-031
3/8	Small	0.505	GC-037
7/16	Small	0.585	GC-043
1/2	Small	0.650	GC-050
5/8	Medium	0.785	GC-062
3/4	Medium	1.030	GC-075



For special sizes and copper grips contact Sunbelt Stud Welding.



website www.sunbeltstudwelding.com email info@sunbeltstudwelding.com
 6381 Windfern Road, Houston, TX 77040 telephone 1.800.462.9353 - Houston 713.939.8903 fax 713.939.9013

Accessories

CHUCKS - TECHNICAL DETAILS

Standard Adjustable Chucks	
Stud Diameter	Part #
2mm (0.079)	CN-002M
#2	CN-008
12 GA & #4	CN-010
3mm (0.116)	CN-003M
1/8 & #5	CN-012
10 GA & #6	CN-013
4mm (0.155)	CN-004M
#8	CN-015
#10	CN-018
5mm (0.196)	CN-005M
6mm (0.236)	CN-006M
0.215	CN-021
0.330	CN-033
1/4	CN-025
5/16	CN-031
8mm (0.315)	CN-008M
3/8	CN-037
10mm (0.390)	CN-010M
7/16	CN-043
12mm (0.472)	CN-012M
1/2	CN-050
14mm (0.551)	CN-014M
9/16	CN-056
5/8	CN-062
16MM (0.63)	CN-016M
0.680	CN-068
18mm (0.708)	CN-018M
3/4	CN-075
7/8	CN-087
20mm (0.787)	CN-020M
1"	CN-100

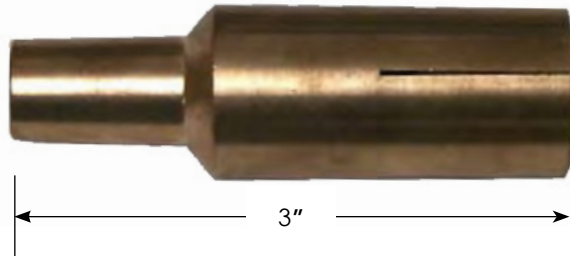
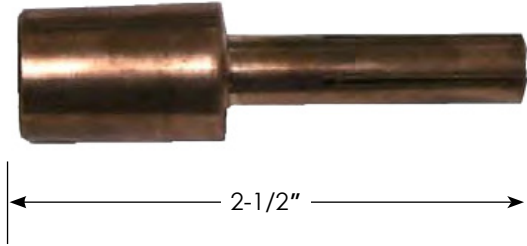

Accessories

CHUCKS - TECHNICAL DETAILS

EURO Standard Adjustable Chucks	
Stud Diameter	Part #
2mm (0.079)	CN-002M - EURO
#2	CN-008 - EURO
12 GA & #4	CN-010 - EURO
3mm (0.116)	CN-003M - EURO
1/8 & #5	CN-012 - EURO
10 GA & #6	CN-013 - EURO
4mm (0.155)	CN-004M - EURO
#8	CN-015 - EURO
#10	CN-018 - EURO
5mm (0.196)	CN-005M - EURO
0.215	CN-021 - EURO
6mm (0.236)	CN-006M - EURO
1/4	CN-025 - EURO
5/16	CN-031 - EURO
8mm	CN-008M - EURO
0.330	CN-033 - EURO
3/8	CN-037 - EURO
10mm (0.390)	CN-010M - EURO
7/16	CN-043 - EURO
12mm (0.472)	CN-012M - EURO
1/2	CN-050 - EURO

EURO Style "Long" & "Extra Long"
Adjustable Chucks available upon request.

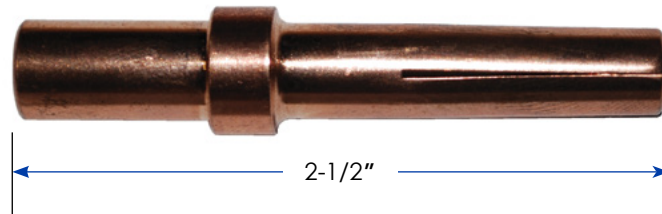

Accessories

LONG AND RECTANGULAR CHUCKS - TECHNICAL DETAILS

3-7/8" Long Adjustable Chucks

Stud Size	Part #
#6	CM-013
#8	CM-015
#10 & 5mm	CM-018
6mm	CM-006M
1/4	CM-025
5/16	CM-031
8mm	CM-008M
0.330	CM-033
3/8	CM-037
10mm	CM-010M
7/16	CM-043
12mm	CM-012M
1/2	CM-050
9/16	CM-056
5/8	CM-062



4-3/4" Extra Long Adjustable Chucks

Stud Size	Part #
#6	CL-013
#8	CL-015
#10	CL-018
1/4	CL-025
5/16	CL-031
3/8	CL-037
7/16	CL-043
1/2	CL-050
5/8	CL-062
3/4	CL-075

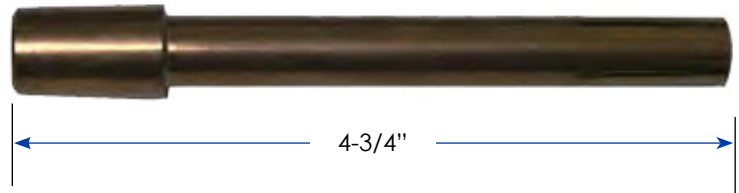

Rectangular Chucks

Stud Size	Part #
1/8 X 1/4	CR-CA
1/8 X 3/8	CR-CB
1/8 X 5/8	CR-CC
1/8 X 3/4	CR-CG
1/8 X 7/8	CR-CH
1/8 X 1"	CR-CE
1/4 X 3/4	CR-CF
1/4 X 1-1/4	CR-CJ

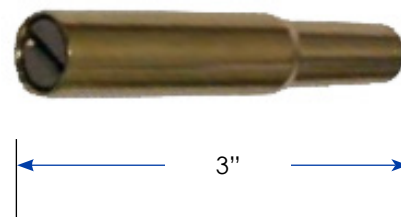

Accessories

HEADED STUD CHUCKS - TECHNICAL DETAILS

3/8" Diameter Headed Anchor Chuck (3/4" Diameter Head)

Part #	Description
CH-037	Complete Assy.
CH-037-1	Sleeve Only
CH-037-2	Base Only
CH-037-3	Stop Screw
SCREWS	10-32 X 3/8

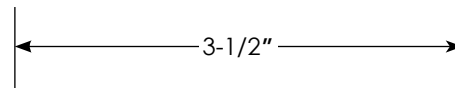

1/2" Diameter Headed Anchor Chuck (1" Diameter Head)

Part #	Description
CH-050	Complete Assy.
CH-050-1	Sleeve Only
CH-050-2	Base Only
CH-050-3	Stop Screw

5/8 & 3/4 Diameter Headed Anchor Chuck (1-1/4" Diameter Head)

Part #	Description
CH-075	Complete Assy.
CH-075-1	Sleeve Only
CH-075-2	Base Only
CH-075-3	Stop Screw

7/8 Diameter Headed Anchor Chuck (1-3/8" Diameter Head)

Part #	Description
CH-087	Complete Assy.
CH-087-1	Sleeve Only
CH-087-2	Base Only
CH-087-3	Stop Screw

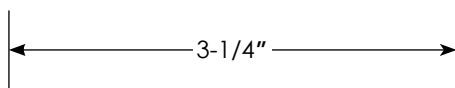

1" Diameter Headed Anchor Chuck (1-5/8" Diameter Head)

Part #	Description
CH-100	Complete Assy.
CH-100-1	Sleeve Only
CH-100-2	Base Only
CH-100-3	Stop Screw
SCREWS	10-32 X 1/2



Accessories

SPECIAL CHUCKS / LEGS - TECHNICAL DETAILS



Y Anchor Chucks	
Anchor Size	Part #
3/16	CY-018
1/4	CY-025
5/16	CY-031



Bent Stud Chuck		
Stud Dia.	Bend	Part #
3/8	90 Degree	CB-037-90
3/8	45 Degree	CB-037-45
1/2	90 Degree	CB-050-90
1/2	45 Degree	CB-050-45
5/8	90 Degree	CB-062-90
5/8	45 Degree	CB-062-45
3/4	90 Degree	CB-075-90
3/4	45 Degree	CB-075-45



Arc Stud Welding Legs		
Length	Diameter	Part #
7"	5/16	L-03107
9"	5/16	L-03109
14"	5/16	L-03114
18"	5/16	L-03118
24"	5/16	L-03124
27"	5/16	L-03127
7"	3/8	L-03707
9"	3/8	L-03709
14"	3/8	L-03714
18"	3/8	L-03718
24"	3/8	L-03724
27"	3/8	L-03727
32"	3/8	L-03732
36"	3/8	L-03736
48"	3/8	L-03748
5/16 Leg Washer		LW-031
5/16 Leg Screw		LS-031
3/8 Leg Washer		LW-037
3/8 Leg Screw		LS-037



Male Chucks	
Hole Size	Part No.
8-32	CX-008-32
10-24	CX-010-24
10-32	CX-010-32
1/4-20	CX-025-20
5/16-18	CX-031-18
3/8-16	CX-037-16
1/2-13	CX-050-13
5/8-11	CX-062-11
3/4-10	CX-075-10
1/4	CX-025
3/8	CX-037
1/2	CX-050
5/8	CX-062

Accessories

WELD THRU DECK ACCESSORIES



Weld Thru Deck (WTD) Foot Assembly	
Part #	Description
B-0021	Foot Assy.
B-0021-1	Foot Only
B-0021-2	Extension Bar
B-0021-3	1/4-20 X 1" Screws



Weld Thru Deck Ferrule Holder	
Part #	Description
B-0060-1	3/4 WTD & 7/8 Flat
B-0060-2	3/4 Flat
B-0060-3	5/8 Flat
B-0060-4	1" Flat
B-0060-5	1/2 Flat

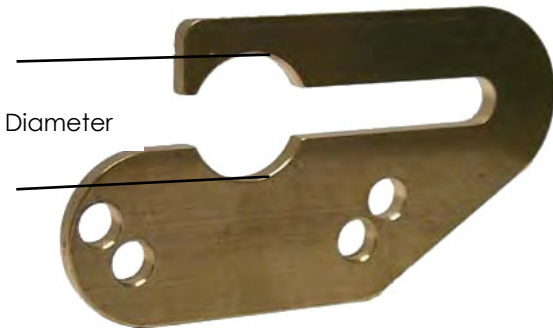

Refractory Ferrule Foot Plate	
Part #	Neck Dia.
QY-025-1	.810
QY-025-2	.930
QY-025-3	1.030



Heavy Duty Ferrule Grip	
Part #	Stud Dia.
GH-050	1/2
GH-062	5/8
GH-075	3/4
GH-087	7/8
GH-100	1"

1/2" HD or WTD Headed Studs require: 5/8" WTD Grip
 5/8" HD or WTD Headed Studs require: 3/4" WTD Grip
 3/4" HD or WTD Headed Studs require: 7/8" WTD Grip
 7/8" HD or WTD Headed Studs require: 1" WTD Grip



website www.sunbeltstudwelding.com email info@sunbeltstudwelding.com
 6381 Windfern Road, Houston, TX 77040 telephone 1.800.462.9353 - Houston 713.939.8903 fax 713.939.9013

Accessories

CLOSED FEET - TECHNICAL DETAILS



B-1N



B-2N



B-3N



B-4N/B-5N



B-6N/B-7N



028-833

Standard Closed Feet		
Gun Type	Stud Size	Part #
Arc Guns - For use with ferrule grips		
USA LD & MD	1/8-1/2"	B-1N
USA HD	1/8-1/2"	B-1N
NS-30 & NS-40	1/8-1/2"	B-6N
EURO LD	1/8-1/2"	H-1N
EURO LD (Alum.)	1/8-1/2"	H-1N-1
USA LD & MD	5/8-3/4"	B-2N
USA HD	5/8-3/4"	B-2N
NS-30 & NS-40	5/8-3/4"	B-7N
EURO MD	5/8-3/4"	H-2N
USA HD	7/8-1"	B-3N
BANTAM A-58	1/8-1/2"	B-4N
BANTAM A-58	5/8-3/4"	B-5N
CD Guns - For use with or without a spark shield		
USA CD FOOT	1/8-3/8"	028-833
EURO CD FOOT	1/8-3/8"	H-2N



Accessories

SPLIT FEET - TECHNICAL DETAILS



B-1C



B-2C



B-3C



B-4C/B-5C



B-4CR/B-5CR



B-6C/B-7C

Standard Split Feet		
Gun Type	Stud Size	Part #
Arc Guns - For use with ferrule grips		
USA LD & MD	1/8-1/2"	B-1C
USA HD	1/8-1/2"	B-1C
NS-30 & NS-40	1/8-1/2"	B-6C
EURO LD	1/8-1/2"	H-1C
USA LD & MD	5/8-3/4"	B-2C
USA HD	5/8-3/4"	B-2C
NS-30 & NS-40	5/8-3/4"	B-7C
EURO MD	5/8-3/4"	H-2C
USA HD	7/8-1"	B-3C
EURO HD	7/8-1"	B-3C
BANTAM A-58	1/8-1/2"	B-4C
BANTAM A-58	5/8-3/4"	B-5C
CD Gun - For use with or without a spark shield		
BANTAM C-2	1/8-3/8"	B-4CR (Recessed)
BANTAM C-2	1/8-3/8"	B-5CR (Recessed)



Accessories

SPECIAL FEET & FERRULE FOOT PLATES

Closed BI-POD Feet		
Gun Type	Stud Size	Part #
USA	1/8-1/2"	BP-1N
USA	5/8-3/4"	BP-2N
USA	7/8-1"	BP-3N



Split BI-POD Feet		
Gun Type	Stud Size	Part #
USA	1/8-1/2"	BP-1C
USA	5/8-3/4"	BP-2C
USA	7/8-1"	BP-3C



Twin Leg Ferrule Foot Plate	
Stud Size	Part #
1/4	QN-025
5/16	QN-031
3/8	QN-037
1/2	QN-050
5/8	QN-062
3/4	QN-075
7/8	QN-087
1"	QN-100



Single Leg Ferrule Foot Plate	
Stud Size	Part #
1/4	QM-025
5/16	QM-031
3/8	QM-037
1/2	QM-050
5/8	QM-062
3/4	QM-075
7/8	QM-087
1"	QM-100



Accessories

SPECIAL ACCESSORIES

Ferrule Tubing				
Stud Size	Part #	I.D.	O.D.	L
#8	MP-015	0.291	0.360	36"
#10	MP-018	0.305	0.375	36"
1/4	MP-025	0.380	0.500	36"
5/16	MP-031	0.445	0.562	36"
3/8	MP-037	0.505	0.625	36"
7/16	MP-043	0.585	0.687	36"
1/2	MP-050	0.650	0.750	36"
5/8	MP-062	0.785	0.906	36"
3/4	MP-075	1.030	1.156	36"

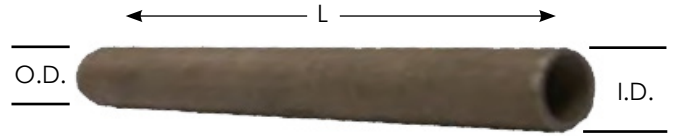

Ferrule Tubing Bushing				
Stud Size	Part #	I.D.	O.D.	Foot Size
#8	MB-015	0.360	0.875	Small
#10	MB-018	0.375	0.875	Small
1/4	MB-025	0.500	0.875	Small
5/16	MB-031	0.562	0.875	Small
3/8	MB-037	0.625	0.875	Small
7/16	MB-043	0.687	0.875	Small
1/2	MB-050	0.750	0.875	Small
5/8	MB-062	0.906	1.156	Medium
3/4	Not required			Medium

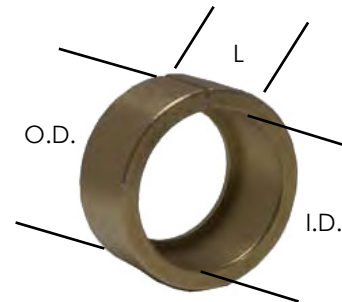

Gas Adapter Feet For Aluminum & Short Cycle Welding



PART # BG-1
Use with Ferrule
USA Gun Type



PART # BG-2	
BG-2-1	Foot Only
BG-2-2	Spark Shield Only
BG-2-3	Valve Assembly
Use without Ferrule	
USA Gun Type	



PART # BG-3	
BG-3-1	Foot Only
BG-3-2	Spark Shield Only
119-0010	Hose Connector
BG-3-XXX	Gas Insert



website www.sunbeltstudwelding.com email info@sunbeltstudwelding.com
 6381 Windfern Road, Houston, TX 77040 telephone 1.800.462.9353 - Houston 713.939.8903 fax 713.939.9013

Accessories

PSR STUD ACCESSORIES

Side Load Chucks			
	Chuck Only	Short Brkt	Long Brkt
Stud Size	Part #	Part #	Part #
3/8	CSLB-037	CSL-037S	CSL-037L
1/2	CSLB-050	CSL-050S	CSL-050L
5/8	CSLB-0562	CSL-062S	CSL-062L
3/4	CSLB-075	CSL-075S	CSL-075L

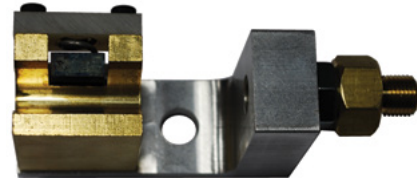

SHORT
VERSION

Side Load Chuck Components	
Component	Part #
Hold Down Finger 3/8, 1/2 & 5/8 Chucks	CSLF
Hold Down Finger 3/4 Chuck	CSLF750
Chuck Isolator	CSLN
Chuck Spring	CSLS
Long Bracket	CSLA-1
Short Bracket	CSLA-2



LONG
VERSION

PSR Twin Leg Ferrule Foot Plate	
Stud Size	Part #
3/8	QNW-037
1/2	QNW-050
5/8	QNW-062
3/4	QNW-075



QNW

Other Needed Accessories	
Component	Part #
Leg Widener	CLSX
Leg Widener - Special	CLSX-S
3/8 X 9" Legs (2 pcs.) Gun to Leg Widener	L-03709
Legs (2 pcs.) Leg Widener To Foot Plate	-A)
(A- length to be determined based on stud length. See Arc Stud Welding Legs for stock lengths.	



CLSX



CLSX-S



Accessories

CAPACITOR DISCHARGE ACCESSORIES

"B" Collets - Standard	
Stud Diameter	Part #
3mm	CDB-003M
14 GA	CDB-008
12 GA & #4	CDB-010
1/8 & #5	CDB-012
10 GA & #6	CDB-013
4mm	CDB-004M
#8	CDB-015
#10	CDB-018
5mm	CDB-005M
0.215	CDB-021
6mm	CDB-006M
1/4	CDB-025
5/16	CDB-031
8mm	CDB-008M
3/8	CDB-037
10mm	CDB-010M



"B" Collets - Short	
Stud Diameter	Part #
14 GA	CDB-008A
12 GA	CDB-010A
#6	CDB-013A
#8	CDB-015A
#10	CDB-018A
1/4	CDB-025A



"B" Stop - For Use With Above "B" Collets		
Stud Length	Stop Length	Part #
1/4	1-1/4	033-781
3/8	1-1/8	033-782
1/2	1"	033-783
5/8	7/8	033-784
3/4	3/4	033-785
7/8	5/8	033-775
1"	1/2	033-776
1-1/8	3/8	033-777
1-1/4	1/4	033-778
1-3/8 (Button Stop)	1/8	033-779
UNIVERSAL		033-780



Short Button Stop



Universal "B" Stop

Accessories

CAPACITOR DISCHARGE ACCESSORIES

HBS "B" Collet with Stop	
Stud Dia.	Part #
2mm (0.79)	CDBHBS-002M
#4 & 12 GA.	CDBHBS-010
3mm (0.116)	CDBHBS-003M
#6 & 10GA.	CDBHBS-013
4mm	CDBHBS-004M
#8	CDBHBS-015
#10	CDBHBS-018
5mm (0.196)	CDBHBS-005M
6mm (0.234)	CDBHBS-006M
1/4	CDBHBS-025
5/16	CDBHBS-031
8mm (0.313)	CDBHBS-008M
3/8	CDBHBS-037
10mm	CDBHBS-010M

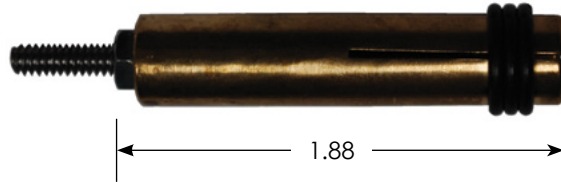

website www.sunbeltstudwelding.com email info@sunbeltstudwelding.com
6381 Windfern Road, Houston, TX 77040 telephone 1.800.462.9353 - Houston 713.939.8903 fax 713.939.9013

Accessories

CAPACITOR DISCHARGE ACCESSORIES

B Collets - Long		
Stud Size	Part #	Cross Ref.
#6	CDBN-013	500-001-356
#8	CDBN-015	500-001-357
#10	CDBN-018	500-001-366
1/4	CDBN-025	500-001-359
5/16	CDBN-031	500-001-360
4 mm	CDBN-004M	500-001-361
6 mm	CDBN-006M	500-001-362
12 GA & #4	CDBN-010	500-001-363

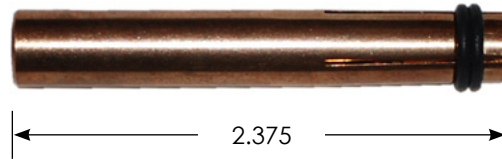

Long Style Adj. Stops For Above		
Stud Length	Part #	Cross Ref.
1/4 TO 5/8	CDBNS-062	500-017-017
3/4 TO 1-1/8	CDBNS-113	500-017-018
1-1/4 TO 1-5/8	CDBNS-162	500-017-019
1-3/4 TO 2-1/8	CDBNS-213	500-017-020
Insulator Only	CDBNS-1	500-017-025



KSM / ERICO	Air Collet
Bottom Load	
Stud Diameter	Part #
#4 (.112)	016-412
#6 (.138)	016-415
#8 (.164)	016-416
#10 (.189)	016-417
1/4 (.250)	016-418

Ram Feed	
Stud Diameter	Part #
#4 (.112)	025-016
#6 (.138)	025-017
#8 (.164)	025-018
#10 (.189)	025-019
1/4 (.250)	025-020



Accessories

CAPACITOR DISCHARGE ACCESSORIES

Collets Inserts For Weld Pins

Stud Diameter X Depth	Part #
12GA X 1/2	CIP-010-050
12GA X 3/4	CIP-010-075
12GA X 1"	CIP-010-100
10GA X 1/2	CIP-014-050
10GA X 3/4	CIP-014-075



Collets Inserts For Weld Studs

Stud Diameter X Depth	Part #	Stud Diameter X Depth	Part #
#4 X 1/4	CI-010-025	#10 X 1/4	CI-018-025
#4 X 3/8	CI-010-037	#10 X 3/8	CI-018-037
#4 X 1/2	CI-010-050	#10 X 1/2	CI-018-050
#4 X 1"	CI-010-100	#10 X 5/8	CI-018-062
#6 X 1/4	CI-013-025	#10 X 3/4	CI-018-075
#6 X 3/8	CI-013-037	#10 X 1"	CI-018-100
#6 X 1/2	CI-013-050	1/4 X 1/4	CI-025-025
#6 X 5/8	CI-013-062	1/4 X 3/8	CI-025-037
#6 X 3/4	CI-013-075	1/4 X 1/2	CI-025-050
#6 X 1"	CI-013-100	1/4 X 5/8	CI-025-062
10 GA X 1/2	CI-014-050	1/4 X 3/4	CI-025-075
10 GA X 3/4	CI-014-075	1/4 X 1"	CI-025-100
10 GA X 1"	CI-014-100	5/16 X 3/8	CI-031-037
#8 X 1/4	CI-015-025	5/16 X 1/2	CI-031-050
#8 X 3/8	CI-015-037	5/16 X 5/8	CI-031-062
#8 X 1/2	CI-015-050	5/16 X 3/4	CI-031-075
#8 X 5/8	CI-015-062	5/16 X 1"	CI-031-100
#8 X 3/4	CI-015-075	3/8 X 1/2	CI-037-050
#8 X 1"	CI-015-100	3/8 X 3/4	CI-037-075
		3/8 X 1"	CI-037-100



Accessories

CAPACITOR DISCHARGE ACCESSORIES

One Piece Contact / Magnetic Chuck

Part #	Description
039-613	Magnetic Chuck - 1 Piece, B Collet Gun
039-613-1	Magnetic Chuck - 1 Piece, Euro Gun



Magnetic Chuck - "B" Collet Gun

Part #	Description
035-301	Complete Assy.
017-633	Magnet Only
029-615	Conductor Plate
039-609	Insul. Tube
039-610	Insul. Disc
Screw	10-32 X 7/8



"B" Collet Protector

Part #	Stud Size
028-837	14 GA X 12 GA
028-838	10 GA
028-836	Body Only
028-834-1	14 GA Insert
028-834	12 GA Insert
028-835	10 GA Insert



Accessories

CAPACITOR DISCHARGE ACCESSORIES

Standard Spark Shield

Part #	Stud Range
033-764	10 GA. - #6
033-765	#8 - 3/8



Vented Spark Shield

Part #	Stud Range
033-769	10 GA. - #6
033-769L	#8 - 3/8
033-769-B	#8 - 3/8, Brass Mat.



Template Tube Adapter

Part #	Template I.D.
039-838	1" Dia.
039-840	1-1/4" Dia.
80-40-513	30mm (Euro Gun)



039-838



80-40-513

Accessories

ADAPTERS



B-CI Adapters	
Part #	Description
044-082	7/8 Long
033-746	1-9/16 Long

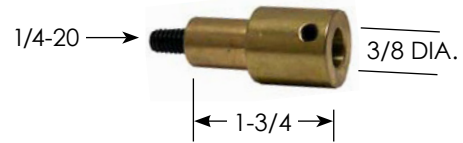

K-B Adapter	
Part #	Description
039-464	1 - 3/4 Long

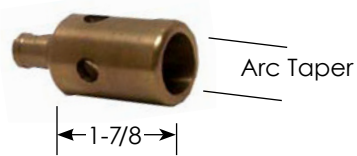

B-N Adapter	
Part #	Description
039-468	1 - 7/8 Long

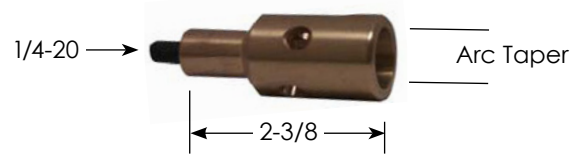

K-N Adapter	
Part #	Description
033-750	2 - 3/8 Long



Tapered Base Adapter	
Part #	I.D.
044-083 N-B	3/8 ID
044-084 N-C	1/4 ID



Threaded Tapered Adapter	
Part #	Description
MT-0003	1/2-20 Thread

Accessories

ADAPTERS

Miscellaneous Adapters	
Part #	Description
033-505	Chuck Adapter Erico HD & MD
033-505T	Chuck Adapter - NEW STYLE
033-506	Connector Stud HD & MD
302-0026	AG Style Chuck Adapter LD
751-458-049	NS-30 Chuck Adapter
82-01-84	NS-40 Chuck Adapter
83-50-012-1	EURO Chuck Adapter HD & MD
80-05-689	EURO Connector Stud HD & MD
033-505L	L-TEC Chuck Adapter
033-601	EURO Gun - B Collet Adapter (Long)
033-601-S	EURO Gun - B Collet Adapter (Short)
033-749	K-CI Adapters



033-505T



033-504



033-506

Arc Template Tube Adapters	
Part #	Description
MT-0008	Under 1/2" Dia., AOL 2", D 1.250 A
MT-0012	5/8 TO 3/4 Dia., AOL 2.5", D 1.562 A
MT-0016	7/8 TO 1 Dia., AOL 2.5", D 2.125 A
92-40-051	Assy., 30MM O.D., L - 34MM B
92-41-051	Assy., 30MM O.D., L - 48MM B
92-42-051	Assy., 30MM O.D., L - 58MM B
80-40-737	Nozzle Only, 30MM, L - 34MM B
80-41-737	Nozzle Only, 30MM, L - 48MM B
80-42-737	Nozzle Only, 30MM, L - 58MM B
A	For use with ceramic ferrule on any gun
B	For use with gas on Euro Arc Guns

Blushing Method

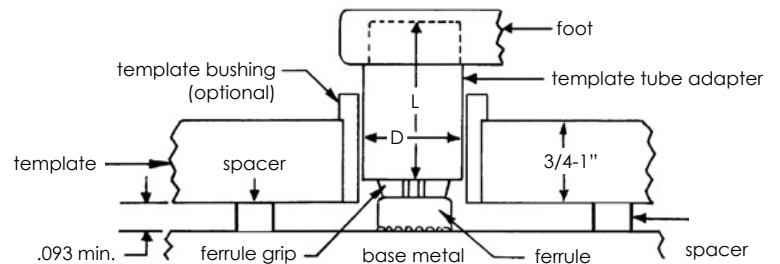

92-4X-051



Accessories

CONTROL CABLE CONNECTORS



107-0015



107-0014



107-0001

Control Cable Connector - 4 & 6 Pole		
Part #	Description	Style
107-0014	MALE 4 Pole Connector	Old
107-0015	FEMALE 4 Pole Connector	Old
107-0001	PANEL Mount Connector	Old
107-1014	MALE 4 Pole Connector	New
107-1015	FEMALE 4 Pole Connector	New
107-1001	PANEL Mount Connector	New
107-2014	MALE 6 Pole Connector	Euro
107-2015	FEMALE 6 Pole Connector	Euro
107-2001	Panel Mount Connector	Euro

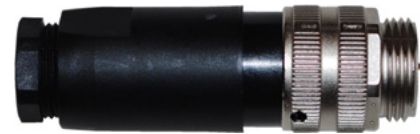

107-1014



107-1015



Arc 2-Wire



Panel Mount



CD Hubbell (M)

Hubbell Style Connector	
Part #	Description
107-0016	Arc 2-Wire (M)
107-0017	Arc 2-Wire (F)
107-0018	Arc 2-Wire (Panel Mount)
107-0019	(M) Rubber Cover
107-0020	(F) Rubber Cover
107-0030	CD Hubbell (M)
107-0032	CD Hubbell (F)
107-0031	CD Hubbell (Panel Mount)



Accessories

WELD CABLE CONNECTORS



Heavy Duty Hi Temp Camlok Connectors			
Part #	Description	Part #	Description
107-0006	4/O (M) HI Temp	107-0007	4/O (F) HI Temp
107-0006-1	4/O (M) Sleeve	107-0007-1	4/O (F) Sleeve
107-0006-2	4/O Brass Only	107-0007-2	4/O Brass Only
107-0007-MF	HI Temp Pin - Fits (M) OR (F)	107-0007-MF	HI Temp Pin - Fits (M) OR (F)
107-0007-CW	Copper Wrap - Fits (M) OR (F)	107-0007-CW	Copper Wrap - Fits (M) OR (F)



Light Duty Connector	
Part #	Description
107-0010	1/O (M) with Fiber Shell
107-0011	1/O (F) with Fiber Shell
107-0012	#4 (M) with Fiber Shell

Accessories

WELD CABLE CONNECTORS

Panel Mount Camlok Connectors

Part #	Description
107-0003	Male Panel Mount
107-0002	Female Panel Mount



Weld Cable Lugs

Part #	Description
123-0003	#4 with #10 Hole
123-0001	#1 with #10 Hole
123-0006	#1 with 1/4 Hole
123-0002	#1 with 3/8 Hole
123-0008	1/O with 3/8 Hole
123-0009	1/O with 1/2 Hole
123-0013	4/O with 3/8 Hole
123-0010	4/O with 1/2 Hole



ALLEN WRENCH & CHUCK EJECTOR

Accessories

Part #	Description
102-0041	Allen Wrench Set - Imperial
102-0041-M	Allen Wrench Set - Metric
102-0042	Chuck Ejector Key

