

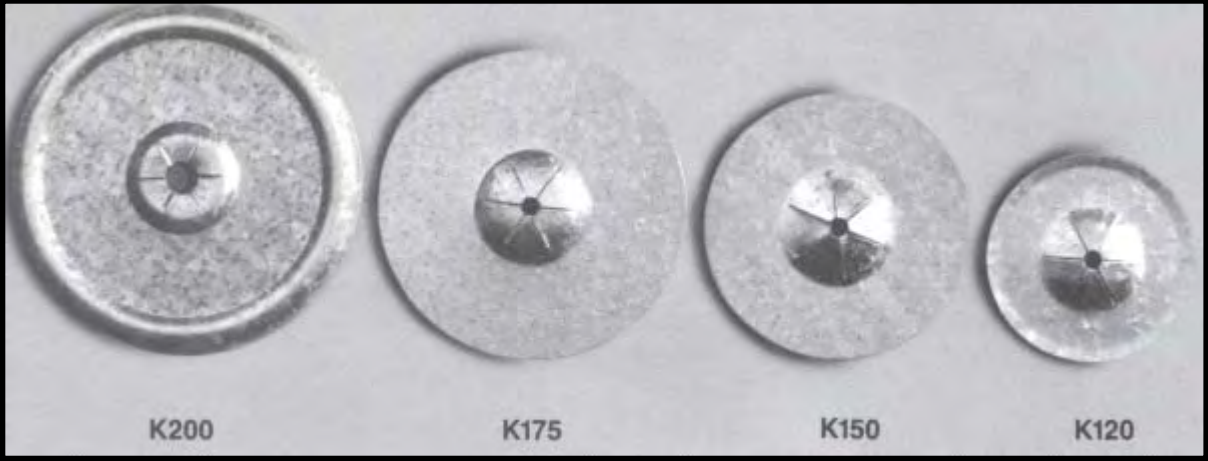

SELF LOCKING WASHERS - ROUND

To order or specify give:
 Product Code: **WCN** Diameter: Type: Specify Material: Specify
Pin on which washer is to be used



TYPE	K200	K175	K150	K120
SIZE	2"	1-3/4	1-1/2	1-3/16
THICKNESS	.015 nom.	.015 nom.	.015 nom.	.015 nom.
MATERIAL	Mild Steel	Mild Steel	Mild Steel	Mild Steel
PLATING	Galvanized	Galvanized	Galvanized	Galvanized
EDGES/FLAT OR BEVELED	beveled	flat	flat	beveled
OTHER MATERIALS AVAILABLE	Alum., S.S.	Alum., S.S.	Alum., S.S.	---
PACKED PER CARTON	2000	1000	1000, 5000	1000, 5000
SHIPPING WEIGHT PER 1,000	19 lbs.	10-1/2 lbs.	8 lbs.	6 lbs.

SUNBELT Self-Locking Washers are used in conjunction with SUNBELT weld pins, insul-anchors and lacing anchors to fasten insulation in place. Simply press the self-locking washer onto the pin up against the insulation until the desired position is reached and then clip off, or bend over, the remaining portion of pin for a permanent attachment.

The choice between round or square self-locking washers is basically a matter of aesthetics or personal preference. The domed, multi-lanced hole design provides for ease of locating washer on pin and positive self-locking. Some styles of washers are manufactured with a beveled edge to prevent the washer from cutting into the insulation facing. SUNBELT Self-Locking Washers are available according to the chart above and with standard 10 GA, 12 GA, or 14 GA hole sizes off-the-shelf. Other material/plating combinations and hole sizes are available by special order.

www.sunbeltstudwelding.com

Sunbelt Stud Welding, Inc.
6381 Windfern Road
Houston, Texas 77040-4915



1-800-462-9353
713-939-8903
fax 713-939-9013



SELF LOCKING WASHERS (SQUARE)

To order or specify give:

Product Code: **WCN** Diameter: Type: Specify Material: Specify
Pin on which washer is to be used

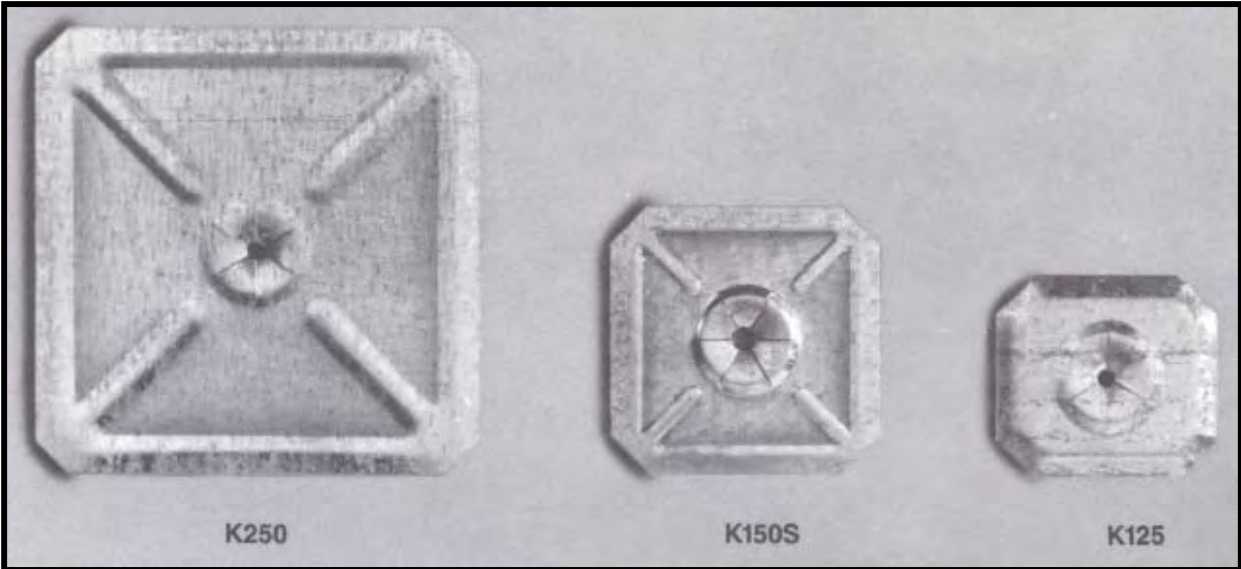

TYPE	K250	K150S	K125
SIZE	2-1/2 x 2-1/2	1-1/2 x 1-1/2	1-1/4 x 1-1/8
THICKNESS	.015 nom.	.015 nom.	.015 nom.
MATERIAL	Mild Steel	Mild Steel	Mild Steel
PLATING	Galvanized	Galvanized	Galvanized
EDGES/FLAT OR BEVELED	beveled	beveled	beveled
OTHER MATERIALS AVAILABLE	Alum., S.S.	Alum., S.S.	Alum., S.S.
PACKED PER CARTON	1000	3000	1000, 5000
SHIPPING WEIGHT PER 1,000	28 - 1/2 lbs.	10 lbs.	6 lbs.

SUNBELT Self-Locking Washers are used in conjunction with **SUNBELT** weld pins, insul-anchors and lacing anchors to fasten insulation in place. Simply press the self-locking washer onto the pin - against the insulation until the desired position is reached and then clip off, or bend over, the remaining portion of pin for a permanent attachment.

The choice between round or square self-locking washers is basically a matter of aesthetics or personal preference. The domed, multi-lanced hole design provides for ease of locating washer on pin and positive self-locking. Some styles of washers are manufactured with a beveled edge to prevent the washer from cutting into the insulation facing. These washers are available according to the chart above and with standard 10 GA, 12 GA, or 14 GA hole sizes off-the-shelf. Other material/plating combinations and hole sizes are available by special order.

www.sunbeltstudwelding.com

Sunbelt Stud Welding, Inc.
 6381 Windfern Road
 Houston, Texas 77040-4915



1-800-462-9353
713-939-8903
fax 713-939-9013



NAVY STUDS - WASHERS, CAPS & NUTS

Annular Ring Cap (for annular ring studs)

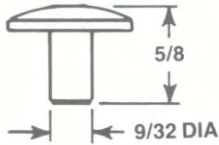

To order or specify give:

Product Code: **WCN AR CAP**

Size: Specify



APPLICATION	Designed to permanently lock on to Navy annular ring studs.
MATERIAL	Mild Steel, 304 Stainless, Aluminum
SIZE	For 3/16" diameter studs.

Key Hole Slotted Washer (for 3/16 diameter notched end studs)

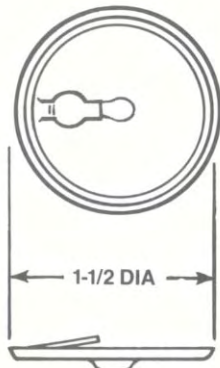

To order or specify give:

Product Code: **WCN NE KHS**

Material: Specify

APPLICATION	Designed to lock on to Navy notched end studs.
MATERIAL	Mild Steel - Cadmium Plated Mild Steel - Galvanized

Flat Washers & Hex Nuts (for all threaded studs)

Note: Most standard hex nuts, flat washers, and lock washers are available in a variety of sizes and materials for threaded mil-spec. Navy studs such as pitch diameter, shoulder, reduced base and collar.

www.sunbeltstudwelding.com

Sunbelt Stud Welding, Inc.
6381 Windfern Road
Houston, Texas 77040-4915



3-3

1-800-462-9353
713-939-8903
fax 713-939-9013



MISCELLANEOUS INSULATION WASHERS

Insulation Washers: Capped Speed Washer

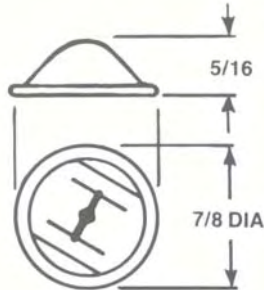

To order or specify give:

Product Code: **WCN CSW** Size: 12 GA Color: Specify

APPLICATION	Designed to permanently lock on to 12 GA weld pins or insul-anchors where appearance is a major factor, or where no sharp points or edges are permissible on the surface.
MATERIAL	Decorative Domed Cap - Aluminum Self-Locking Insert - Hardened Steel
COLOR	Plain (bright aluminum) or painted white. Other painted colors are available by special order.

Insulation Washers: Prong Washer



To order or specify give:

Product Code: **WCN P150** Material: Specify

APPLICATION	Designed to be used with Sunbelt Stud Welding Prong Insul-Anchors. Slide over prong and bend prong tabs down in opposite directions.
MATERIAL	Mild Steel - Galvanized and Aluminum. Stainless Steel is available by special order.
SLOT SIZE	3/32" x 13/16"

Insulation Washers: Lacing Washer & Ring

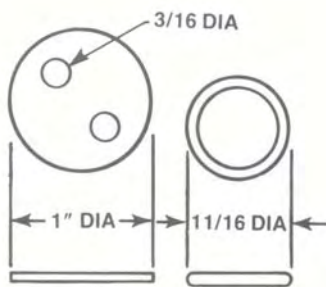

To order or specify give:

Product Code: **LA L100 or LA RING** Material: (Washer)

APPLICATION	Designed to be used with lacing wire to wrap insulation around irregular shapes.
MATERIAL	Washer - Aluminum or Stainless Steel Ring - Zinc alloy, bright zinc plated
NO-AB	Washers are available stamped NO AB to indicate non-asbestos material

www.sunbeltstudwelding.com

Sunbelt Stud Welding, Inc.
6381 Windfern Road
Houston, Texas 77040-4915



1-800-462-9353
713-939-8903
fax 713-939-9013



PANEL CAPS & NUTS

Annular Groove Cap (for annular groove shoulder studs)

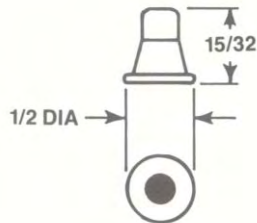

To order or specify give:
Product Code: **WCN AG CAP**

APPLICATION	Designed to permanently lock on to annular groove shoulder studs to hold panel in place against stud shoulder.
MATERIAL	Aluminum
SIZE	For 3/16" diameter annular groove.

Cap Setting Tool (for installing AG Caps)



To order or specify give:
Name: **Cap Setting Tool**

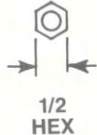

APPLICATION	This tool is recommended for installing the Annular Groove Cap (above).
--------------------	---

Panel Nut (for 1/4-20 threaded studs)

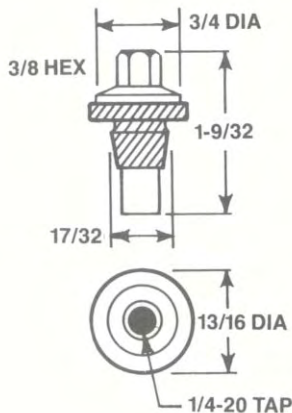

To order or specify give:
Product Code: **WCN PANUT**

APPLICATION	Designed to be threaded down through pre-drilled holes in the panel on to pre-welded studs providing firm, water resistant attachment.
MATERIAL	Aluminum & Neoprene Rubber
SIZE	For 1/4-20 threaded studs

www.sunbeltstudwelding.com

Sunbelt Stud Welding, Inc.
6381 Windfern Road
Houston, Texas 77040-4915



3-5

1-800-462-9353
713-939-8903
fax 713-939-9013



REFRACTORY ANCHORS - WASHERS & RETAINERS

Insul-twist Washer

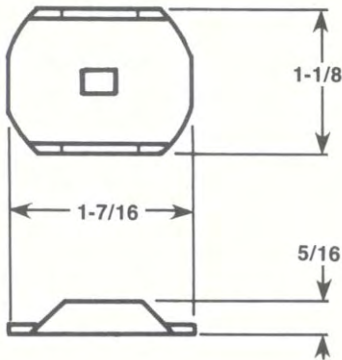

To order or specify give:
 Product Code: **WCN ITW** Length: Specify Size: Specify Material: Specify

APPLICATION Designed for 1/4 turn locking on to SUNBELT INSULTWIST refractory anchors.

MATERIAL
 Stainless Steel: 304
 Stainless Steel: 310
 Stainless Steel: 330
 Inconel: 601

WASHER Sold seperately. Not a component part of stud.

Insul-twist Cup

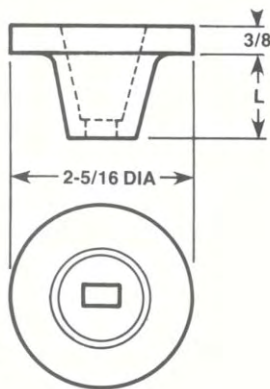

To order or specify give:
 Product Code: **WCN ITC** Length: **L**

APPLICATION Designed for 1/4 turn locking on to Sunbelt Stud Welding Insultwist refractory anchors.

MATERIAL Ceramic (High Temperature)

SIZE
 L Short - 1"
 Long - 2"

www.sunbeltstudwelding.com

Sunbelt Stud Welding, Inc.
 6381 Windfern Road
 Houston, Texas 77040-4915



1-800-462-9353
713-939-8903
fax 713-939-9013



REFRACTORY - DRIVE PLATE

Drive Plate

To order or specify give:
Product Code: **WCN DRPLT**

APPLICATION	Designed to lock on to Sunbelt Stud Welding 5/16" diameter Knurled Studs.
MATERIAL	Mild Steel

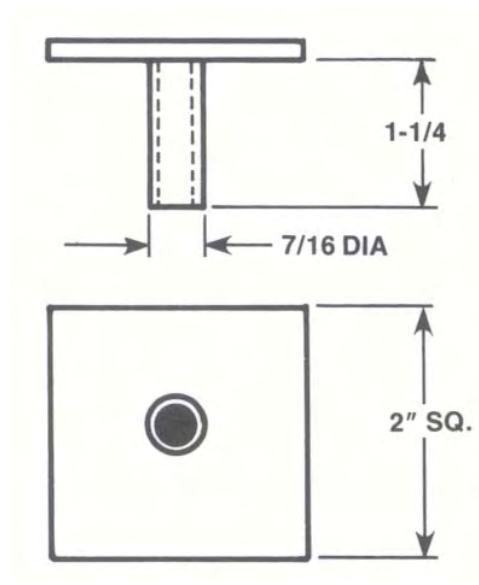

www.sunbeltstudwelding.com

Sunbelt Stud Welding, Inc.
6381 Windfern Road
Houston, Texas 77040-4915



1-800-462-9353
713-939-8903
fax 713-939-9013



STANDARD HEX NUTS

HEX NUTS (American Standard)

WCN HEX

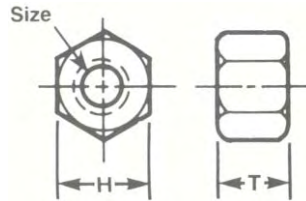

SIZE	H	T
#6	5/16	7/64
#8	11/32	1/8
#10	3/8	1/8
1/4	7/16	7/32
5/16	1/2	17/64

SIZE	H	T
3/8	9/16	21/64
7/16	11/16	3/8
1/2	3/4	7/16
5/8	15/16	35/64
3/4	1-1/8	41/64

HEX JAM NUTS (American Standard)

WCN HEXJAM

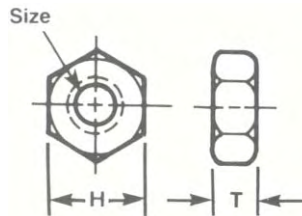

SIZE	H	T
1/4	7/16	5/32
5/16	1/2	3/16
3/8	9/16	7/32
7/16	11/16	1/4

SIZE	H	T
1/2	3/4	5/16
5/8	15/16	3/8
3/4	1-1/8	27/64

www.sunbeltstudwelding.com

Sunbelt Stud Welding, Inc.
6381 Windfern Road
Houston, Texas 77040-4915



3-8

1-800-462-9353
713-939-8903
fax 713-939-9013



STANDARD FLAT WASHERS

FLAT WASHERS (American Standard – Type A, Series W)

WCN FLAT

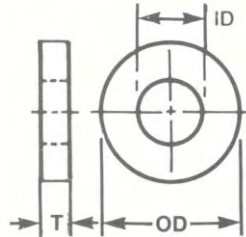

SIZE	ID	OD	T
#6	5/32	3/8	3/64
#8	3/16	7/16	3/64
#10	7/32	1/2	3/64
1/4	5/16	47/64	1/16
5/16	3/8	7/8	5/64

SIZE	ID	OD	T
3/8	7/16	1"	5/64
7/16	1/2	1-1/4	5/64
1/2	9/16	1-3/8	7/64
5/8	11/16	1-3/4	9/64
3/4	13/16	2"	5/32

LARGE OD FLAT WASHERS (American Standard – Type B, Series W) WCN LODFLT

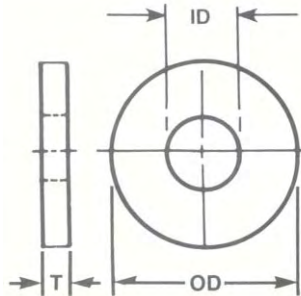

SIZE	ID	OD	T
1/4	9/32	1"	1/16
5/16	11/32	1-1/8	1/16
3/8	13/32	1-1/4	3/32
7/16	15/32	1-15/32	3/32

SIZE	ID	OD	T
1/2	17/32	1-3/4	3/32
5/8	21/32	2-1/4	5/32
3/4	13/16	2-1/2	5/32

www.sunbeltstudwelding.com

Sunbelt Stud Welding, Inc.
6381 Windfern Road
Houston, Texas 77040-4915



1-800-462-9353
713-939-8903
fax 713-939-9013



STANDARD LOCK WASHERS

SPLIT LOCK WASHER

WCN SPLIT

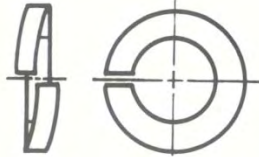

SIZES									
#6	#8	#10	1/4	5/16	3/8	7/16	1/2	5/8	3/4

INTERNAL TOOTH LOCK WASHER

WCN INT



SIZES					
#6	#8	#10	1/4	5/16	3/8

EXTERNAL TOOTH LOCK WASHER

WCN EXT



SIZES					
#6	#8	#10	1/4	5/16	3/8

INTERNAL/EXTERNAL TOOTH LOCK WASHER

WCN INTEXT

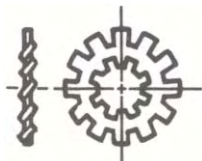

SIZES					
#6	#8	#10	1/4	5/16	3/8

TYPE & SIZE: Types and sizes shown are standard. Many other types and sizes are available by special order. All dimensions shown are $\pm 1/64$ ".

MATERIAL: HEX NUTS and FLAT WASHERS are available in mild steel (unplated or zinc plated), stainless steel, aluminum and brass. LOCK WASHERS are available in mild steel (unplated or zinc plated) and stainless steel. Other materials are available by special order.

TO ORDER OR SPECIFY: Give Product code (WCN) + size + material.

www.sunbeltstudwelding.com

Sunbelt Stud Welding, Inc.
6381 Windfern Road
Houston, Texas 77040-4915



1-800-462-9353
713-939-8903
fax 713-939-9013