

CD Weld Studs

CAR – CD ANNULAR RING (NAVY) STUDS -TECHNICAL DETAILS

CAR weld studs are available in mild steel and stainless steel materials.

CAR weld studs are used to install insulation materials. After the stud is welded in place, the insulation is impaled over the stud and then a Mushroom Navy Cap is installed onto the stud with a hammer. The cap is now locked onto the stud.

For application, dimensional and in stock assistance contact Sunbelt Stud Welding.

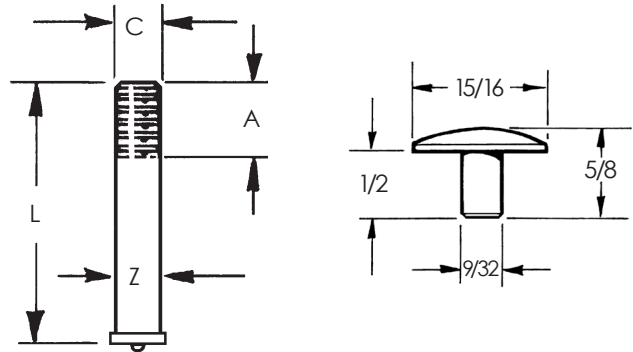

Stud Specifications				Standard Accessories				
Nominal Diameter	Groove Diameter	Groove Length	Min. Length	B Collet Standard 1-3/8" Long	B Collet Short 1-3/16" Long	Long Collet 2-3/8" Long	Euro Collet 1.80 Long	Collet Inserts 1-3/4" Long
Z	C	A	L	P/N *	P/N *	P/N **	P/N	P/N ***
0.188	0.175	0.312	0.750	CDB-018	CDB-018A	CDBN-018	CDBS-018	CI-010-XXX
* Note, requires B Stop, see Accessories for details								
** Note, Requires Long Style Stops, see Accessories for details								
*** Note, Collet Inserts are specific to stud length, see accessories for details.								

To order or specify give: Stud Code, Z x L, Material and Quantity
 Example: CAR, .188 x .75, Mild Steel, 2000 pcs.

Materials

Low Carbon Steel - conforms to MIL-S-24149 (Tensile 60,000 PSI min. and yield 50,000 PSI min.)

Copper Plating is standard

Stainless Steel - conforms to MIL-S-24149 (Tensile 85,000 PSI min. and yield 40,000 PSI min.)

Recommended Hardware:	Part Number
Mushroom Navy Cap - Aluminum	AR-001
To order indicate P/N and Quantity - item sold separately	

See **Accessories** for accessory details. See **CD Stud Welding General Information** and **Technical Details** for process description, material combinations, reverse-side marking, locating options, technical details, guidelines, torque valves, weight charts and standard stock sizes.

