

Arc Weld Studs - Externally Threaded

TS - THREADED SHOULDER WELD STUDS - TECHNICAL DETAILS

TS studs are available in mild steel and stainless steel materials. As most TS studs are made to each customer's order, the customer can specify all dimensions when ordering.

TS studs are used to provide a spacer between the base metal and the attached part.

For application and dimensional assistance, contact Sunbelt Stud Welding.

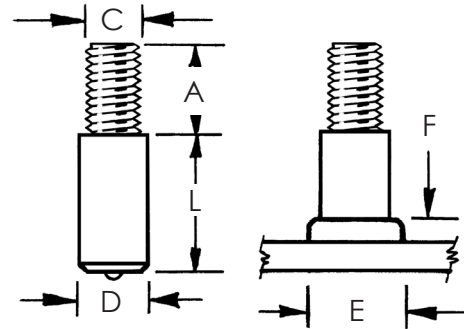

Stud Specifications						Standard Accessories			
Base Diameter	Max. Thread Diameter	Min. Thread Length	Min. Base Length	Flash Dimensions		Ferrule	Foot	Grip	Chuck*
D	C	A	L	E	F	P/N	P/N	P/N	P/N
0.250	#8	0.250	0.312	0.359	0.109	F025-F	B-1N	GN-025	CN-015
0.312	#10	0.250	0.312	0.438	0.109	F031-F	B-1N	GN-031	CN-018
0.375	1/4 - 20	0.250	0.312	0.500	0.125	F037-F	B-1N	GN-037	CN-025
0.438	5/16 - 18	0.312	0.350	0.578	0.141	F043-F	B-1N	GN-043	CN-031
0.500	3/8 - 16	0.375	0.375	0.688	0.156	F050-F	B-1N	GN-050	CN-037
0.625	1/2 - 13	0.500	0.500	0.797	0.188	F062-F	B-2N	GN-062	CN-050
0.750	5/8 - 11	0.562	0.625	0.938	0.250	F075-F	B-2N	GN-075	CN-062
0.875	3/4 - 10	0.625	0.625	1.094	0.313	F087-F	B-3N	GN-087	CN-075
1.000	7-8 - 9	0.750	0.720	1.250	0.375	F100-F	B-3N	GN-100	CN-087

* Chuck part number provided is for the Threaded Diameter (C) shown.

To order or specify give: Stud Code, Base diameter, Length, Thread Size, Thread Length, Material and Quantity
Example: TS, .500 x 1.00, 3/8-16 x 5/8, (BW), 304 SS, 2200 pcs.
Specify (L) Length on a Before Weld basis by indicating "BW" or on an After Weld basis by indicating "AW."

See **Accessories** for accessory detail and **Ferrule Specifications** for ferrule options.

See **Arc Stud Welding - General Information** and **Technical Details** for industry specifications, thread options, Before Weld (BW) length, flux, raw material details, plating options, annealing, load strengths and shipping weights.

