

# Arc Weld Studs - No Thread Studs

## NTS – NO THREAD SHOULDER WELD STUDS – TECHNICAL DETAILS

NTS weld studs are available in mild steel and stainless steel materials.

NTS studs are used for locating pins, spacers, stops, stand offs and rotational points.

For application, dimensional and in stock assistance, please contact Sunbelt Stud Welding.

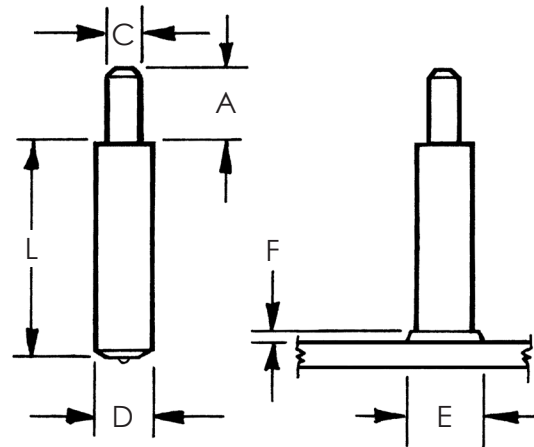

Stud Specifications						Standard Accessories			
Base Diameter	No Thread Diameter	Min. No Thread Length	Min. Length	Flash Dimensions		Ferrule	Foot	Grip	Chuck*
D	C	A	L	E	F	P/N	P/N	P/N	P/N
0.250	Customer to specify this dimension.	0.250	0.312	0.359	0.109	F025-F	B-1N	GN-025	CN-025
0.312		0.250	0.312	0.438	0.109	F031-F	B-1N	GN-031	CN-031
0.375		0.250	0.312	0.500	0.125	F037-F	B-1N	GN-037	CN-037
0.438		0.250	0.350	0.578	0.141	F043-F	B-1N	GN-043	CN-043
0.500		0.250	0.375	0.688	0.156	F050-F	B-1N	GN-050	CN-050
0.625		0.250	0.500	0.797	0.188	F062-F	B-2N	GN-062	CN-062
0.750		0.250	0.625	0.938	0.250	F075-F	B-2N	GN-075	CN-075
0.875		0.250	0.625	1.094	0.313	F087-F	B-3N	GN-087	CN-087
1.000		0.250	0.720	1.250	0.375	F100-F	B-3N	GN-100	CN-100

\* Chuck part number shown is for the Base Diameter "D" shown.

To order or specify give: Stud Code, Diameter, Length, C dia., A Dimension, Material and Quantity

Example: NTS, 5/16 x 1.00, (BW), with .188 x .375, mild steel, 2000 pcs.

Specify (L) Length, on a Before Weld basis by indicating "BW"  
or on an After Weld basis by indicating "AW."

See **Accessories** for accessory detail and **Ferrule Specifications** for ferrule options.

See **Arc Stud Welding – General Information** and **Technical Details** for industry specifications, thread options, Before Weld (BW) length, flux, raw material details, plating options, annealing, load strengths and shipping weights.

