

Arc Weld Studs - No Thread Studs

NTB – BENT NO THREAD – ARC WELD STUD

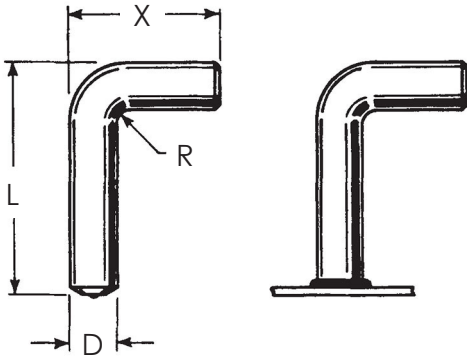

Stud				
D	Min. L	Min. X	Min. R	Ferrule Code
1/4	1-1/8	1-1/4	.125	F250
5/16	1-1/4	1-1/2	.218	F312
3/8	1-1/2	1-1/2	.218	F375
7/16	1-5/8	1-5/8	.250	F437
1/2	1-3/4	1-3/4	.250	F500
5/8	1-7/8	2	.312	F625
3/4	2-3/4	3	.500	F750
7/8	3-1/2	3-3/8	.500	F875

Material	Mild Steel		Stainless Steel
	C - 0.23% max. Mn - 0.90% max.	P - 0.04% max. S - 0.05% max.	AISI grade - 302/304/305/316 std. Other grades available upon request.
Mechanical Properties	Tensile	60,000 psi (min.)	Values for various grades available upon request.
	Yield	50,000 psi (min.)	
	Elongation	20% (in 2 inches)	
Plating	Plating is not standard. Cadmium, Copper, Nickel, and Zinc available upon customer request.		Does not apply to Stainless.

To order or specify give: Stud Code, Diameter, Length, Material and Quantity.

Example: NTB, 1/4, 2 (BW), Mild Steel, 5000 pcs.

Specify (L) Length, on a Before Weld basis by indicating "BW"
or on an After Weld basis by indicating "AW."

See **Accessories** for accessory detail and **Ferrule Specifications** for ferrule options.

See **Arc Stud Welding – General Information** and **Technical Details** for industry specifications, thread options, Before Weld (BW) length, flux, raw material details, plating options, annealing, load strengths and shipping weights.

