

Aluminum Shoulder Base Welding Pins

ALUMINUM SHOULDER BASE WELDING PINS

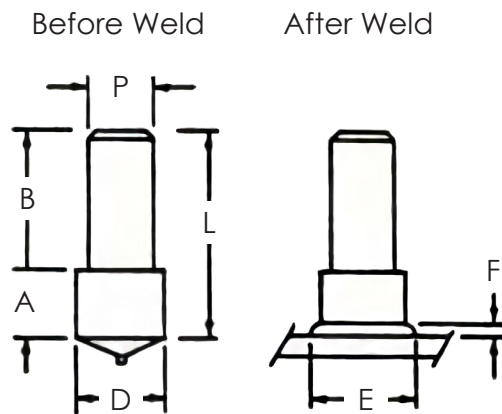

Aluminum SB (Shoulder Base) welding pins are plain, unthreaded fasteners with a weld base diameter greater than the extension diameter. Available with weld base diameters from 1/4" through 1/2"; extension diameters, 1/8" through 3/8".

Typical Use: As standoff and pivot between parent metal and rotating arm or wheel.

Length Specifications: Overall length limits are established by the combination of A and B.

Material: Aluminum alloy 5000 Series.

Ferrules: All orders include ferrules, which are supplied with the studs and are not sold individually.

Specifications								
Pin Diameter	Weld Base Diameter (Nom.)	Weld Base Length		Maximum Pin Length	Maximum Overall Length		Approximate Weld Bead Dimensions	
		Before Weld	After Weld (Nom.)		B/W L (BW)	A/W L (AW)	Diameter E	Height F
P	D	A (BW)	A (AW)	B	B/W L (BW)	A/W L (AW)	E	F
1/8	1/4	5/16	1/8	5/16	5/8	7/16	13/32	1/8
3/16	5/16	3/8	3/16	15/32	27/32	21/32	15/32	5/32
1/4	3/8	13/32	7/32	5/8	1-1/32	25/32	5/8	3/16
5/16	7/16	15/32	9/32	25/32	1-1/4	1-1/16	21/32	7/32
3/8	1/2	1/2	5/16	1	1-1/2	1-5/16	3/4	1/4

To order or specify give: Stud Code, D, P, A (BW), B, Material and Quantity

Example: Aluminum Shoulder Base Pins, 1/4, 1/8, 5/16 (BW), 5/16, Aluminum alloy 5000 Series, 2000 pcs.

Specify (L) Length, on a Before Weld basis by indicating "BW" or on an After Weld basis by indicating "AW."

